

# PUBLIC NOTICE

US Army Corps  
of Engineers  
New York District  
Jacob K. Javits Federal Building  
New York, N.Y. 10278-0090  
ATTN: Regulatory Branch

**In replying refer to:**  
Public Notice Number: **NAN-2022-00248-EMI**  
Issue Date:  
Expiration Date:

---

## To Whom It May Concern:

The New York District, Corps of Engineers has received an application for a Department of the Army permit pursuant to Section 10 of the Rivers and Harbors Act of 1899 (33 U.S.C. 403) and Section 404 of the Clean Water Act (33 U.S.C. 1344).

**APPLICANT:** New York City Department of Parks and Recreation  
117-02 Roosevelt Avenue  
Olmsted Center  
Flushing Meadows Corona Park  
Flushing, New York 11368

**ACTIVITY:** Shoreline Stabilization

**WATERWAY:** Hutchinson River

**LOCATION:** Pelham Bay Landfill - Borough of The Bronx, Bronx County, City of New York, New York

A detailed description and plans of the applicant's activity are enclosed to assist in your review.

The decision whether to issue a permit will be based on an evaluation of the probable impact including cumulative impacts of the proposed activity on the public interest. That decision will reflect the national concern for both protection and utilization of important resources. The benefit which reasonably may be expected to accrue from the proposal must be balanced against its reasonably foreseeable detriments. All factors which may be relevant to the proposal will be considered including the cumulative effects thereof; among those are conservation, economics, aesthetics, general environmental concerns, wetlands, historic properties, fish and wildlife values, flood hazards, floodplain values, land use, navigation, shoreline erosion and accretion, recreation, water supply and conservation, water quality, energy needs, safety, food and fiber production, mineral needs, considerations of property ownership and, in general, the needs and welfare of the people.

The Corps of Engineers is soliciting comments from the public; Federal, state, and local agencies and officials; Indian Tribes; and other interested parties in order to consider and evaluate the impacts of this proposed activity. Any comments received will be considered by the Corps of Engineers to determine whether to issue, modify, condition or deny a permit for this proposal. To make this decision, comments are used to assess impacts on endangered species, historic properties, water quality, general environmental effects, and the other public interest factors listed above. Comments are used in preparation of an Environmental Assessment and/or an Environmental Impact Statement pursuant to the National Environmental Policy Act. Comments are also used to determine the need for a public hearing and to determine the overall public interest of the proposed activity.

**CENAN-OP-RE**  
**PUBLIC NOTICE NO. NAN-2020-00248-EMI**

ALL COMMENTS REGARDING THE PERMIT APPLICATION MUST BE PREPARED IN WRITING AND EMAILED TO REACH THIS OFFICE BEFORE THE EXPIRATION DATE OF THIS NOTICE, otherwise, it will be presumed that there are no objections to the activity.

Comments submitted in response to this notice will be fully considered during the public interest review for this permit application. Comments provided will become part of the public record for this permit application. All written comments, including contact information, will be made a part of the administrative record, available to the public under the Freedom of Information Act. The Administrative Record, or portions thereof, may also be posted on a Corps of Engineers internet web site. Due to resource limitations, this office will normally not acknowledge the receipt of comments or respond to individual letters of comment.

Any person may request, in writing, before this public notice expires, that a public hearing be held to collect information necessary to consider this application. Requests for public hearings shall state, with particularity, the reasons why a public hearing should be held. It should be noted that information submitted by email is considered just as carefully in the permit decision process and bears the same weight as that furnished at a public hearing.

Our preliminary determination is that the activity for which authorization is sought herein is not likely to affect any Federally endangered or threatened species or their critical habitat. However, pursuant to Section 7 of the Endangered Species Act (16 U.S.C. 1531), the District Engineer is consulting with the appropriate Federal agency to determine the presence of and potential impacts to listed species in the project area or their critical habitat.

The Magnuson-Stevens Fishery Conservation and Management Act, as amended by the Sustainable Fisheries Act (Public Law 104-267), requires all Federal agencies to consult with the National Oceanic and Atmospheric Administration Fisheries Service (NOAA/FS) on all actions, or proposed actions, permitted, funded, or undertaken by the agency, that may adversely affect Essential Fish Habitat (EFH). The proposed work, fully described in the attached work description, could cause the disruption of habitat for various lifestages of some EFH-designated species as a result of a temporary increase in turbidity during construction. However, the New York District has made the preliminary determination that the site-specific adverse effects are not likely to be substantial because it is expected that fish populations would avoid the small area of disturbance. Further consultation with NOAA/FS regarding EFH impacts and conservation recommendations is being conducted and will be concluded prior to the final decision.

Based upon a review of the latest published version of the National Register of Historic Places, there are no known sites eligible for, or included in, the Register within the permit area. Presently unknown archeological, scientific, prehistorical, or historical data may be lost by work accomplished under the required permit.

Reviews of activities pursuant to Section 404 of the Clean Water Act will include application of the guidelines promulgated by the Administrator, U.S. Environmental Protection Agency, under authority of Section 404 (b) of the Clean Water Act and the applicant will obtain a water quality certificate or waiver from the appropriate state agency in accordance with Section 401 of the Clean Water Act prior to a permit decision.

Pursuant to Section 307 (c) of the Coastal Zone Management Act of 1972 as amended [16 U.S.C. 1456 (c)], for activities under consideration that are located within the coastal zone of a state which has a federally approved coastal zone management program, the applicant has certified in the permit application that the activity complies with, and will be conducted in a manner that is consistent

**CENAN-OP-RE**  
**PUBLIC NOTICE NO. NAN-2020-00248-EMI**

with, the approved state coastal zone management program. By this public notice, we are requesting the state's concurrence with, objection to, or waiver of the applicant's certification. No permit decision will be made until one of these actions occur. For activities within the coastal zone of New York State, the applicant's certification and accompanying information is available from the Consistency Coordinator, New York State Department of State, Division of Coastal Resources and Waterfront Revitalization, Coastal Zone Management Program, One Commerce Plaza, 99 Washington Avenue, Albany, New York 12231, Telephone (518) 474-6000. Comments regarding the applicant's certification, and copies of any letters to this office commenting upon this proposal, should be so addressed.

In addition to any required water quality certificate and coastal zone management program concurrence, the applicant has obtained or requested the following governmental authorization for the activity under consideration:

- New York State Department of Environmental Conservation

It is requested that you communicate the foregoing information concerning the activity to any persons known by you to be interested and who did not receive a copy of this notice. Please send all comments and questions concerning this application to [Christopher.W.Minck@usace.army.mil](mailto:Christopher.W.Minck@usace.army.mil).

In order for us to better serve you, please complete our Customer Service Survey located at <http://www.nan.usace.army.mil/Missions/Regulatory/CustomerSurvey.aspx>.

For more information on New York District Corps of Engineers programs, visit our website at <http://www.nan.usace.army.mil>.

**FOR AND IN BEHALF OF**  
Stephan A. Ryba  
Chief, Regulatory Branch

Enclosures

**WORK DESCRIPTION**

The permit applicant, New York City Department of Parks and Recreation (NYCDPR) has requested Department of the Army (DA) authorization to stabilize the shoreline along the former Pelham Bay landfill. The project is located in Hutchinson River at the Pelham Bay Landfill in the Borough of The Bronx, Bronx County, City of New York, New York.

The proposed work would involve the following:

Construct a new approximately 3,900 linear riprap revetment in three sections (Southern, Eastern, and Northeast) along the former Pelham Bay landfill by constructing a new stone berm atop the existing stone seawall and riprap. The stone berm will have a 1:1.5 slope to an elevation of 19.5 feet NAVD88 and a crest of six feet in width. Approximately 8,044 cubic yards of stone fill will be discharged below the plane of Spring High Water over approximately 84,358 square feet (1.93 acres) to facilitate the construction of the new stone berm atop the existing riprap.

The applicant has stated that they have avoided, minimized, and mitigated for potential impacts proposed to the maximum extent practicable by completing all work from land and using silt fencing around the project area to prevent materials from entering the waterway. Additionally the applicant has designed the project to construct the riprap atop the existing stone to minimize the fill required to construct the new berm.

The stated purpose of this project is to stabilize the shoreline and to increase the resiliency of the site and protect the former landfill from exposure. The project is receiving grant funding from the Federal Emergency Management Agency (FEMA).



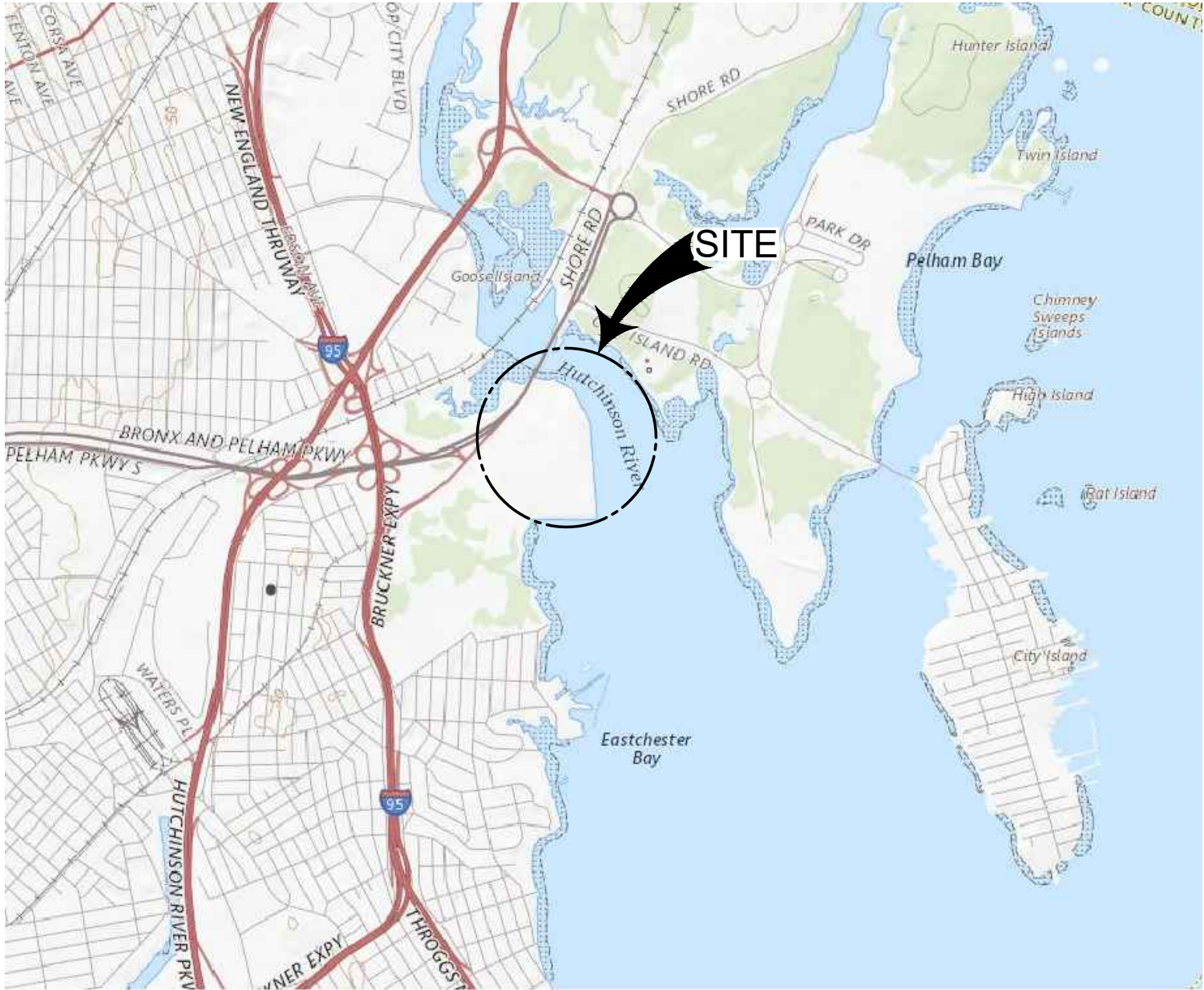

LOCATION MAP

N.T.S.

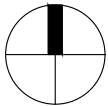

PURPOSE: SHORELINE  
STABILIZATION

DATUM: NAVD88

ADJACENT OWNERS:

1. SEE ATTACHED LIST IN PERMIT  
PACKAGE

PELHAM BAY LANDFILL

APPLICANT: NYC DEPARTMENT OF PARKS  
AND RECREATION  
117-02 ROOSEVELT AVENUE  
FLUSHING, NY 11368

AGENT: M.G. McLAREN, P.C.  
131 W 35TH STREET, 4TH FLR  
NEW YORK, NY 10001

LOCATION MAP

IN: EASTCHESTER BAY  
AT: BRONX AND PELHAM BAY  
PARKWAY  
COUNTY OF: BRONX STATE: NY

SHT 1 OF 30

E:\na\projects\proj1601\160466\_31\10\_Dwg\pelham bay landfill\CAUD\USACE\4-5 Existing Partial Plans.dwg PLOT TIME: Thu, 02 Mar 2023 - 9:46am LAST SAVE: Wed, 12 Jan 2022 - 4:52pm BY: jgones

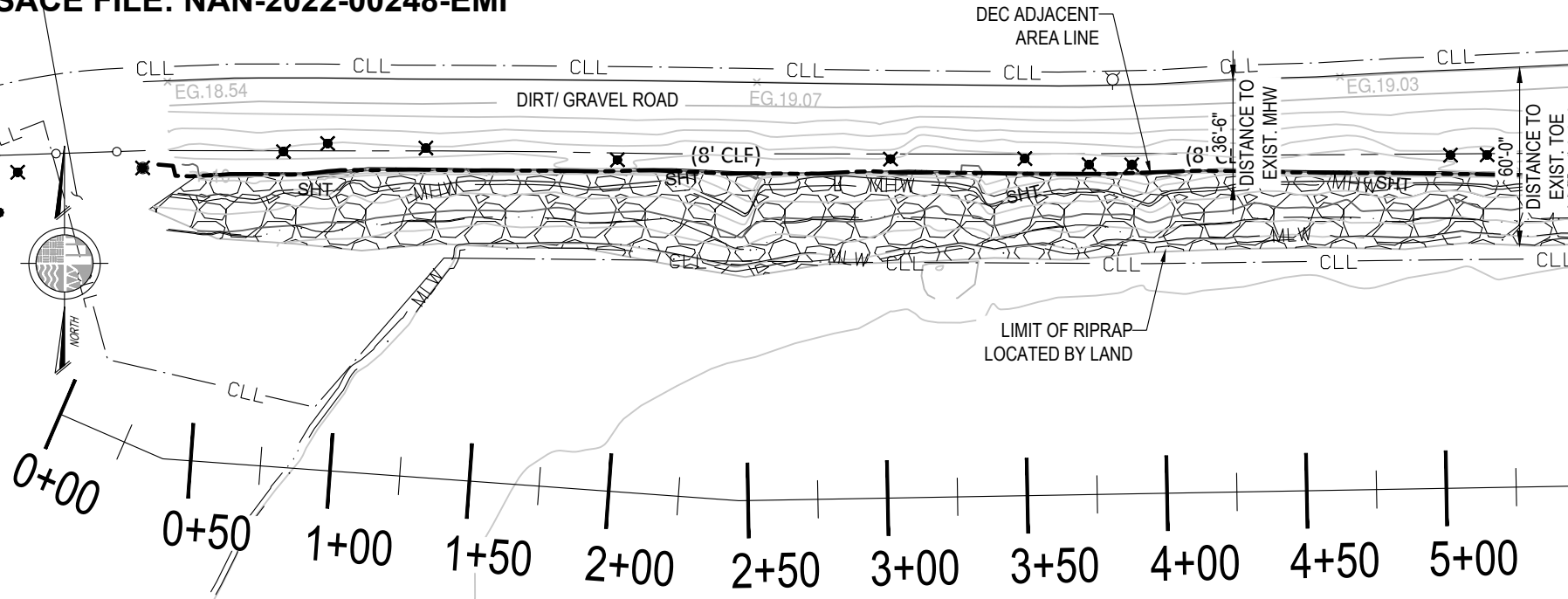

- LINETYPE LEGEND:**
- MLW - - - - - MLW
  - MHW - - - - - MHW
  - SHT - - - - - SHT
  - - - - - MAJOR CONTOUR
  - - - - - MINOR CONTOUR
  - (8' CLF) - - - - - 8' CHAIN LINK FENCE
  - - - - - CLL - CONTRACTOR LIMIT LINES
  - - - - - DEC ADJACENT AREA LINE
  - - - - - SECURITY FENCE, SEE NOTE 4
  - - - - - REFERENCE LINE
  - ✕ REMOVE TREE
  - SIGN
  - MONITORING WELL
  - [RIPRAP SYMBOL] RIPRAP

**EXISTING PARTIAL PLAN  
- STA 0+00 TO STA 5+50**

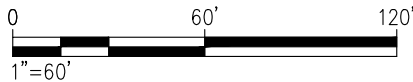

- NOTES:**
1. THE SURVEY WAS COMPLETED BY MCLAREN ENGINEERING GROUP ON 03/18/2020.
  2. VERTICAL DATUM IS FT NAVD88, HORIZONTAL DATUM IS NAD83 NY LONG ISLAND STATE PLANE.
  3. FEDERAL NAVIGATION CHANNEL IS APPROXIMATELY 1,300 FT FROM THIS PROJECT SITE.
  4. 63 TREES TO BE REMOVED.
  5. DEC ADJACENT AREA LINE WAS OBTAINED BY COMBINING THE CURRENT CONTOUR AT EL 10' NAVD88, AND THE EL 10' CONTOUR IN 1966.

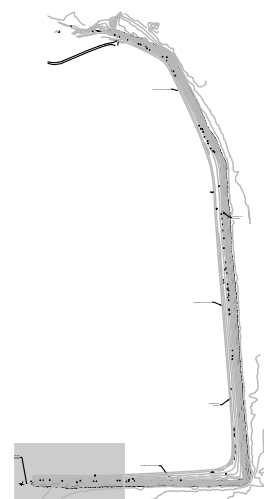

**KEY PLAN**

PURPOSE: SHORELINE STABILIZATION DATUM: NAVD 88 ADJACENT OWNERS: 1. SEE ATTACHED LIST IN PERMIT PACKAGE.  AGENT: M.G. McLAREN, P.C. 131 W 35TH ST, 4TH FLR, NEW YORK, NY 10001	PELHAM BAY LANDFILL		EXISTING PARTIAL PLAN - STA 0+00 TO STA 5+50
	IN: EASTCHESTER BAY AT: BRONX AND PELHAM BAY PARKWAY COUNTY OF: BRONX STATE: NY	APPLICANT: NYC DEPARTMENT OF PARKS AND RECREATION 117-02 ROOSEVELT AVENUE FLUSHING, NY 11368	02/17/2023  SHT 4 OF 30

FILE NAME: \\nyddad\projects\proj60160466-31\0\_Dwg\pelham bay landfill\CAUD\USACE\4-5 Existing Partial Plans.dwg PLOT TIME: Thu, 02 Mar 2023 - 9:46am LAST SAVE: Wed, 12 Jan 2022 - 4:52pm Bk: jgones

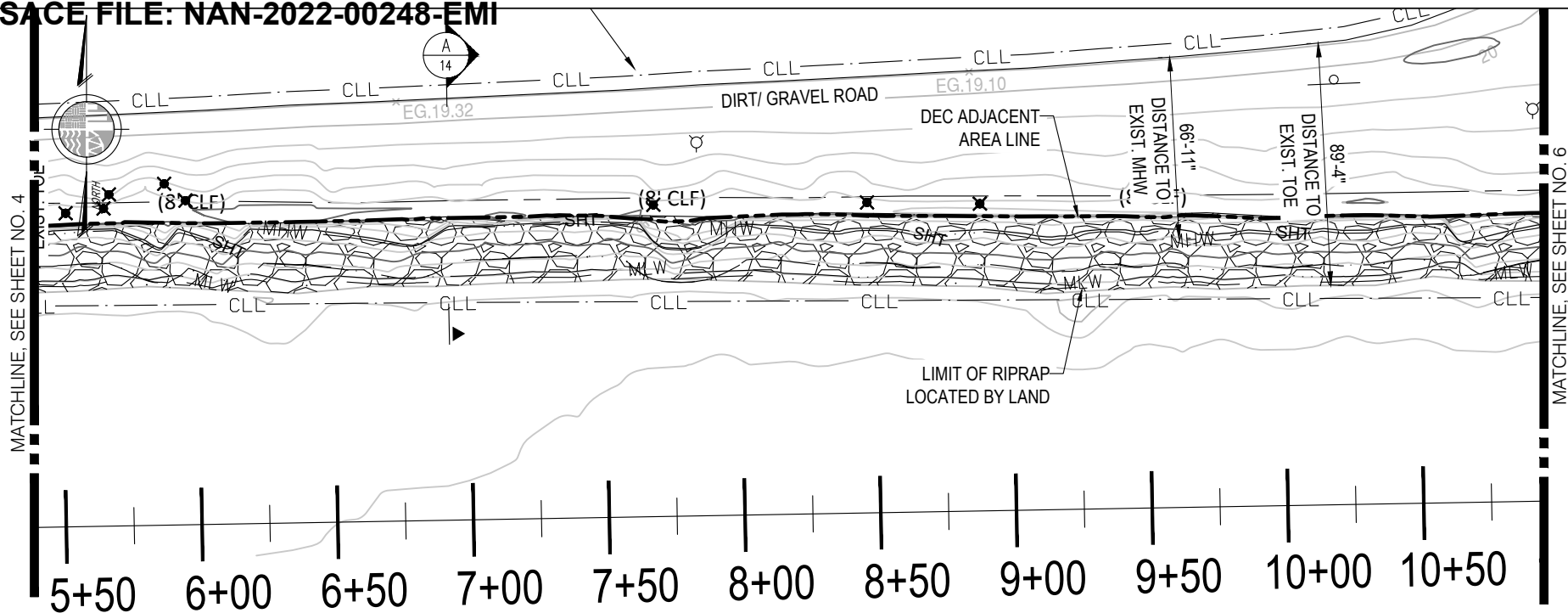

**LINETYPE LEGEND:**

- MLW ——— MLW
- MHW ——— MHW
- SHT ——— SHT
- MAJOR CONTOUR
- MINOR CONTOUR
- (8' CLF) — 8' CHAIN LINK FENCE
- ——— CLL — CONTRACTOR LIMIT LINES
- ——— DEC ADJACENT AREA LINE
- SECURITY FENCE, SEE NOTE 4
- ——— REFERENCE LINE
- ✕ REMOVE TREE
- SIGN
- MONITORING WELL
- [RIPRAP SYMBOL] RIPRAP

**EXISTING PARTIAL PLAN-  
STA 5+50 TO STA 10+75**

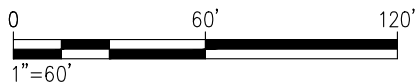

**NOTES:**

1. THE SURVEY WAS COMPLETED BY McLAREN ENGINEERING GROUP ON 03/18/2020.
2. VERTICAL DATUM IS FT NAVD88, HORIZONTAL DATUM IS NAD83 NY LONG ISLAND STATE PLANE.
3. FEDERAL NAVIGATION CHANNEL IS APPROXIMATELY 1,300 FT FROM THIS PROJECT SITE.
4. 63 TREES TO BE REMOVED.
5. DEC ADJACENT AREA LINE WAS OBTAINED BY COMBINING THE CURRENT CONTOUR AT EL 10' NAVD88, AND THE EL 10' CONTOUR IN 1966.

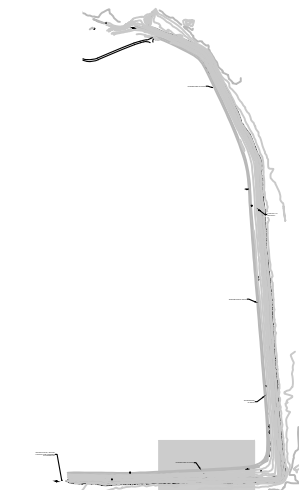

**KEY PLAN**

PURPOSE: SHORELINE STABILIZATION  
 DATUM: NAVD 88  
 ADJACENT OWNERS:  
 1. SEE ATTACHED LIST IN PERMIT PACKAGE.

AGENT: M.G. McLAREN, P.C.  
 131 W 35TH ST, 4TH FLR, NEW YORK, NY 10001

**PELHAM BAY LANDFILL**

IN: EASTCHESTER BAY  
 AT: BRONX AND PELHAM BAY PARKWAY  
 COUNTY OF: BRONX STATE: NY

APPLICANT: NYC DEPARTMENT OF  
 PARKS AND RECREATION  
 117-02 ROOSEVELT AVENUE  
 FLUSHING, NY 11368

EXISTING PARTIAL PLAN -  
 STA 5+50 TO STA 10+75

02/17/2023

SHT 5 OF 30

\\nyddad\Projects\160466-3\10-Dwg\pelham bay landfill\CAUD\USACE\4-5-Existing Partial Plans.dwg PLOT TIME: Thu 02 Mar 2023 - 9:50am LAST SAVE: Wed 12 Jan 2022 - 4:56pm BY: jgrces

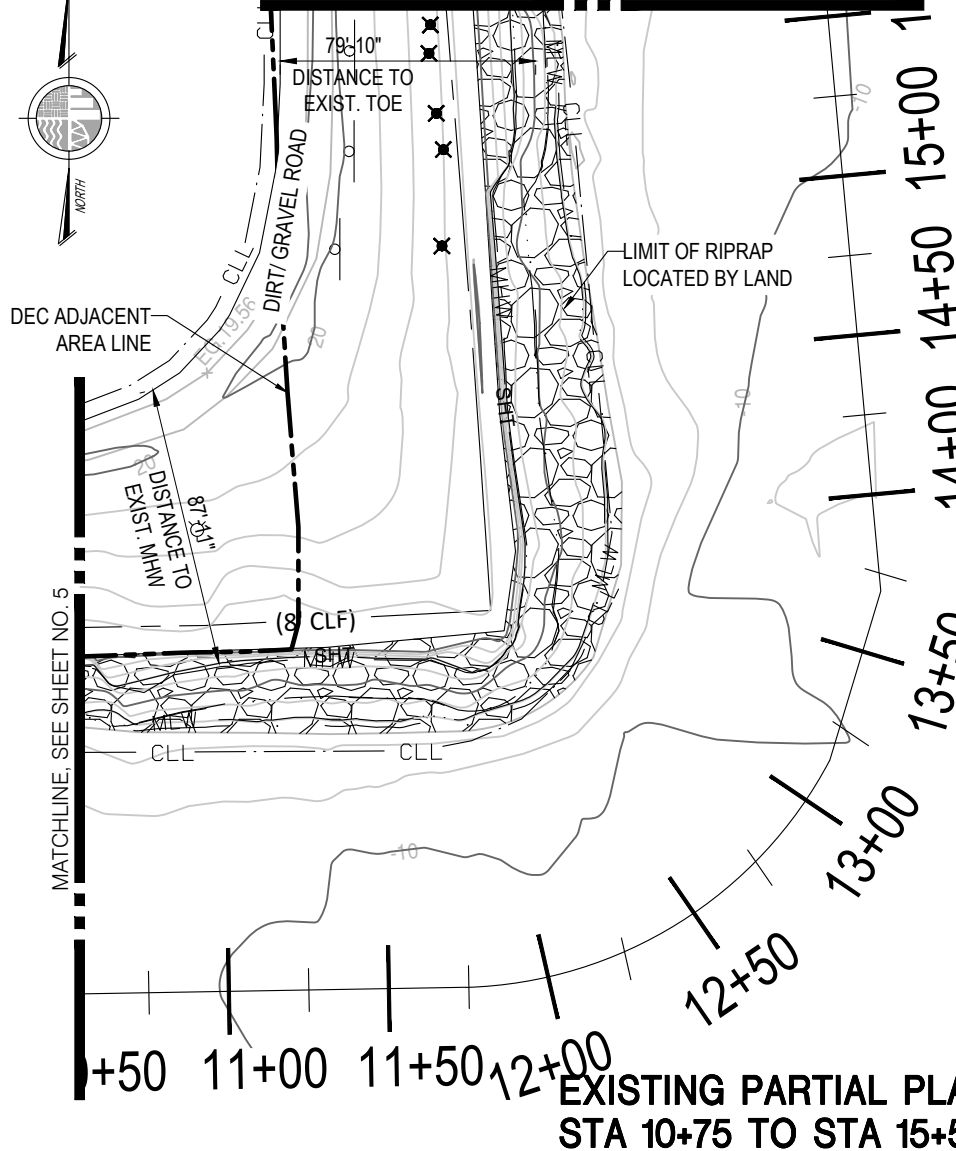

**LINETYPE LEGEND:**

- MLW - - - - - MLW
- MHW - - - - - MHW
- SHT - - - - - SHT
- MAJOR CONTOUR
- MINOR CONTOUR
- (8' CLF) - - - - - 8' CHAIN LINK FENCE
- CLL — CONTRACTOR LIMIT LINES
- DEC ADJACENT AREA LINE
- — SECURITY FENCE, SEE NOTE 4
- REFERENCE LINE
- ✕ — REMOVE TREE
- — SIGN
- — MONITORING WELL
- [Pattern] — RIPRAP

**NOTES:**

1. THE SURVEY WAS COMPLETED BY MCLAREN ENGINEERING GROUP ON 03/18/2020.
2. VERTICAL DATUM IS FT NAVD88, HORIZONTAL DATUM IS NAD83 NY LONG ISLAND STATE PLANE.
3. FEDERAL NAVIGATION CHANNEL IS APPROXIMATELY 1,300 FT FROM THIS PROJECT SITE.
4. 63 TREES TO BE REMOVED.
5. DEC ADJACENT AREA LINE WAS OBTAINED BY COMBINING THE CURRENT CONTOUR AT EL 10' NAVD88, AND THE EL 10' CONTOUR IN 1966.

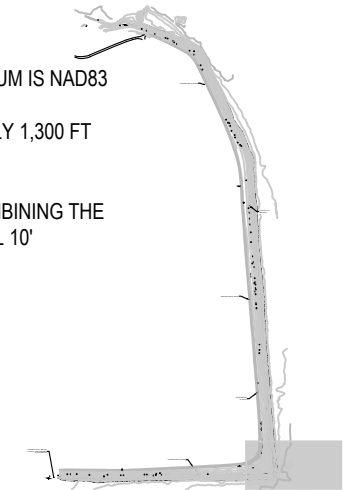

**KEY PLAN**

**EXISTING PARTIAL PLAN-  
STA 10+75 TO STA 15+50**

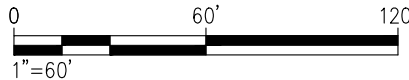

PURPOSE: SHORELINE STABILIZATION  
 DATUM: NAVD 88  
 ADJACENT OWNERS:  
 1. SEE ATTACHED LIST IN PERMIT PACKAGE.

AGENT: M.G. McLAREN, P.C.  
 131 W 35TH ST, 4TH FLR, NEW YORK, NY 10001

PELHAM BAY LANDFILL

IN: EASTCHESTER BAY  
 AT: BRONX AND PELHAM BAY PARKWAY  
 COUNTY OF: BRONX STATE: NY

APPLICANT: NYC DEPARTMENT OF  
 PARKS AND RECREATION  
 117-02 ROOSEVELT AVENUE  
 FLUSHING, NY 11368

EXISTING PARTIAL PLAN-  
 STA 10+75 TO STA 15+50

02/17/2023

SHT 6 OF 30



- NOTES:**
1. THE SURVEY WAS COMPLETED BY MCLAREN ENGINEERING GROUP ON 03/18/2020.
  2. VERTICAL DATUM IS FT NAVD88, HORIZONTAL DATUM IS NAD83 NY LONG ISLAND STATE PLANE.
  3. FEDERAL NAVIGATION CHANNEL IS APPROXIMATELY 1,300 FT FROM THIS PROJECT SITE.
  4. 63 TREES TO BE REMOVED.
  5. DEC ADJACENT AREA LINE WAS OBTAINED BY COMBINING THE CURRENT CONTOUR AT EL 10' NAVD88, AND THE EL 10' CONTOUR IN 1966.

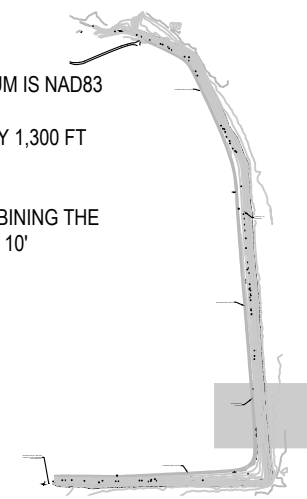

## KEY PLAN

PURPOSE: SHORELINE STABILIZATION DATUM: NAVD 88 ADJACENT OWNERS: 1. SEE ATTACHED LIST IN PERMIT PACKAGE.  AGENT: M.G. McLAREN, P.C. 131 W 35TH ST, 4TH FLR, NEW YORK, NY 10001	PELHAM BAY LANDFILL		EXISTING PARTIAL PLAN- STA 15+50 TO STA 18+75
	IN: EASTCHESTER BAY AT: BRONX AND PELHAM BAY PARKWAY COUNTY OF: BRONX      STATE: NY	APPLICANT: NYC DEPARTMENT OF PARKS AND RECREATION 117-02 ROOSEVELT AVENUE FLUSHING, NY 11368	02/17/2023   SHT 7      OF 30

## LINETYPE LEGEND:

—MLW	----	MLW
—MHW	----	MHW
—SHT	----	SHT
—	----	MAJOR CONTOUR
—	----	MINOR CONTOUR
—(8' CLF)	----	8' CHAIN LINK FENCE
—CLL	----	CONTRACTOR LIMIT LINES
—	----	DEC ADJACENT AREA LINE
—○—	----	SECURITY FENCE, SEE NOTE 4
—	----	REFERENCE LINE
✕		REMOVE TREE
○		SIGN
○		MONITORING WELL
		RIPRAP

## NOTES:

1. THE SURVEY WAS COMPLETED BY McLAREN ENGINEERING GROUP ON 03/18/2020.
2. VERTICAL DATUM IS FT NAVD88, HORIZONTAL DATUM IS NAD83 NY LONG ISLAND STATE PLANE.
3. FEDERAL NAVIGATION CHANNEL IS APPROXIMATELY 1,300 FT FROM THIS PROJECT SITE.
4. 63 TREES TO BE REMOVED.
5. DEC ADJACENT AREA LINE WAS OBTAINED BY COMBINING THE CURRENT CONTOUR AT EL 10' NAVD88, AND THE EL 10' CONTOUR IN 1966.

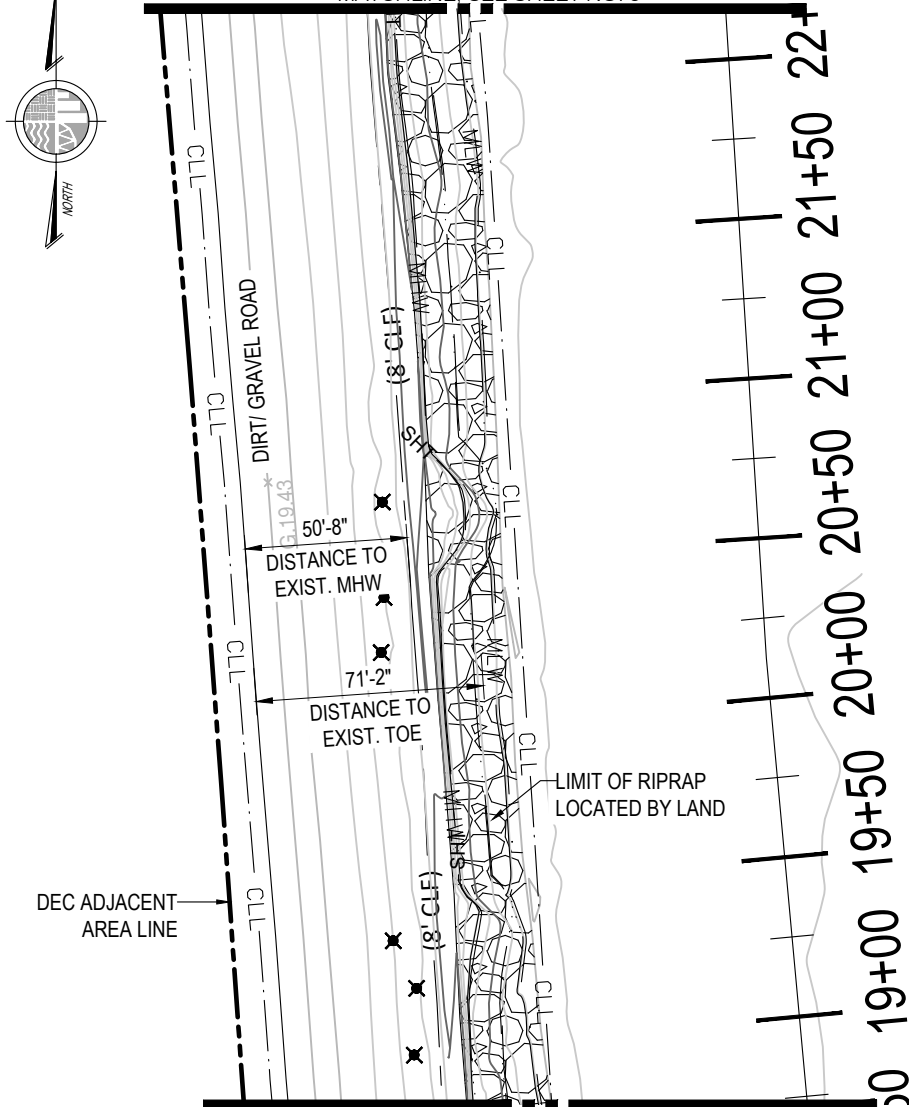

## EXISTING PARTIAL PLAN- STA 18+75 TO STA 22+00

## KEY PLAN

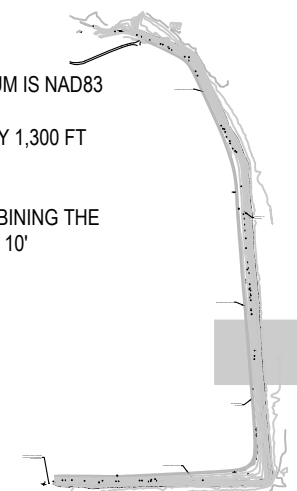

PURPOSE: SHORELINE STABILIZATION

DATUM: NAVD 88

ADJACENT OWNERS:

1. SEE ATTACHED LIST IN PERMIT PACKAGE.

AGENT: M.G. McLAREN, P.C.

131 W 35TH ST, 4TH FLR, NEW YORK, NY 10001

## PELHAM BAY LANDFILL

IN: EASTCHESTER BAY  
AT: BRONX AND PELHAM BAY PARKWAY  
COUNTY OF: BRONX STATE: NY

APPLICANT: NYC DEPARTMENT OF  
PARKS AND RECREATION  
117-02 ROOSEVELT AVENUE  
FLUSHING, NY 11368

EXISTING PARTIAL PLAN-  
STA 18+75 TO STA 22+00

02/17/2023

SHT 8 OF 30

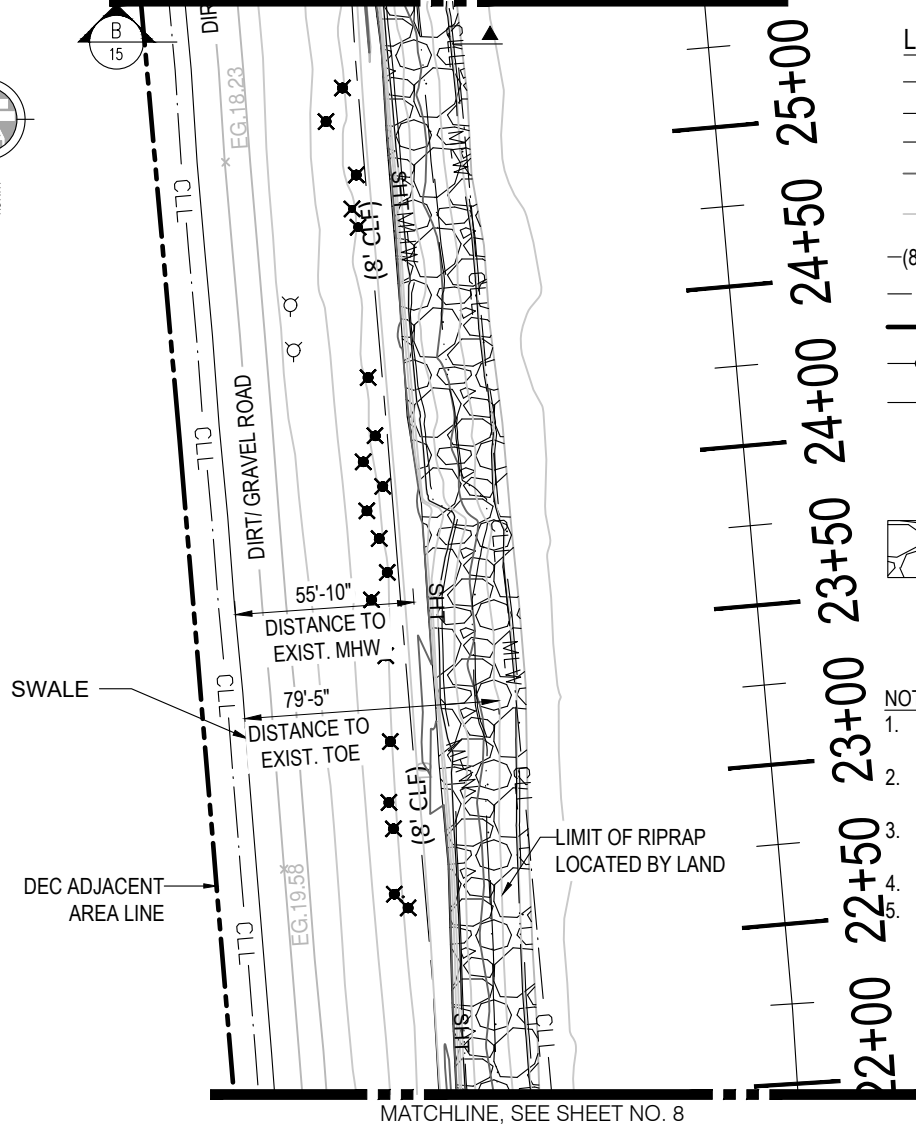

**LINETYPE LEGEND:**

- MLW - - - - - MLW
- MHW - - - - - MHW
- SHT - - - - - SHT
- - - - - MAJOR CONTOUR
- - - - - MINOR CONTOUR
- (8' CLF) - - - - - 8' CHAIN LINK FENCE
- - - - - CLL - - - - - CONTRACTOR LIMIT LINES
- - - - - DEC ADJACENT AREA LINE
- - - - - SECURITY FENCE, SEE NOTE 4
- - - - - REFERENCE LINE
- ✕ - - - - - REMOVE TREE
- - - - - - SIGN
- - - - - - MONITORING WELL
- [Pattern] - - - - - RIPRAP

**NOTES:**

1. THE SURVEY WAS COMPLETED BY McLAREN ENGINEERING GROUP ON 03/18/2020.
2. VERTICAL DATUM IS FT NAVD88, HORIZONTAL DATUM IS NAD83 NY LONG ISLAND STATE PLANE.
3. FEDERAL NAVIGATION CHANNEL IS APPROXIMATELY 1,300 FT FROM THIS PROJECT SITE.
4. 63 TREES TO BE REMOVED.
5. DEC ADJACENT AREA LINE WAS OBTAINED BY COMBINING THE CURRENT CONTOUR AT EL 10' NAVD88, AND THE EL 10' CONTOUR IN 1966.

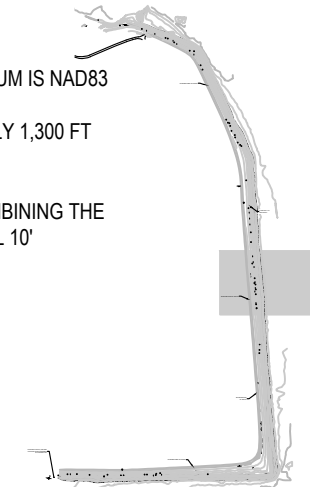

**KEY PLAN**

**EXISTING PARTIAL PLAN- STA 22+00 TO STA 25+25**

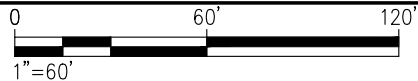

PURPOSE: SHORELINE STABILIZATION

DATUM: NAVD 88

ADJACENT OWNERS:

1. SEE ATTACHED LIST IN PERMIT PACKAGE.

AGENT: M.G. McLAREN, P.C.

131 W 35TH ST, 4TH FLR, NEW YORK, NY 10001

**PELHAM BAY LANDFILL**

IN: EASTCHESTER BAY  
AT: BRONX AND PELHAM BAY PARKWAY  
COUNTY OF: BRONX STATE: NY

APPLICANT: NYC DEPARTMENT OF  
PARKS AND RECREATION  
117-02 ROOSEVELT AVENUE  
FLUSHING, NY 11368

EXISTING PARTIAL PLAN-  
STA 22+00 TO STA 25+25

02/17/2023

SHT 9 OF 30

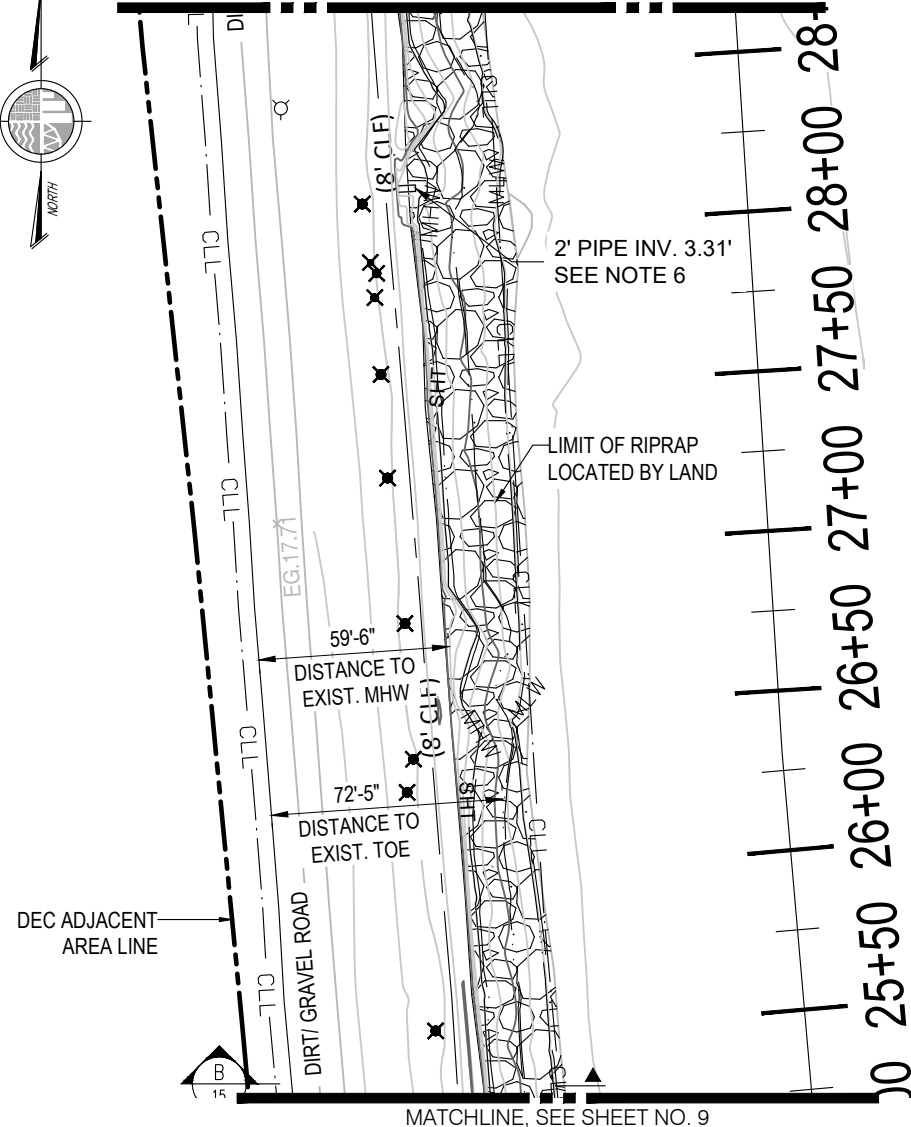

## EXISTING PARTIAL PLAN- STA 25+25 TO STA 28+50

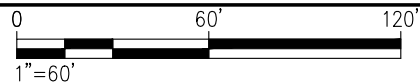

### LINETYPE LEGEND:

—MLW	----	MLW
—MHW	----	MHW
—SHT	----	SHT
—	----	MAJOR CONTOUR
—	----	MINOR CONTOUR
—(8' CLF)	----	8' CHAIN LINK FENCE
—CLL	----	CONTRACTOR LIMIT LINES
—	----	DEC ADJACENT AREA LINE
—○—○—	----	SECURITY FENCE, SEE NOTE 4
—	----	REFERENCE LINE
✕		REMOVE TREE
○		SIGN
○		MONITORING WELL
		RIPRAP

### NOTES:

1. THE SURVEY WAS COMPLETED BY McLAREN ENGINEERING GROUP ON 03/18/2020.
2. VERTICAL DATUM IS FT NAVD88, HORIZONTAL DATUM IS NAD83 NY LONG ISLAND STATE PLANE.
3. FEDERAL NAVIGATION CHANNEL IS APPROXIMATELY 1,300 FT FROM THIS PROJECT SITE.
4. 63 TREES TO BE REMOVED.
5. DEC ADJACENT AREA LINE WAS OBTAINED BY COMBINING THE CURRENT CONTOUR AT EL 10' NAVD88, AND THE EL 10' CONTOUR IN 1966.

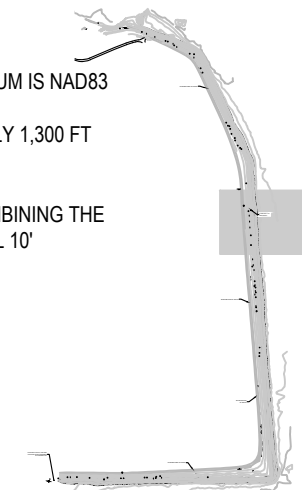

## KEY PLAN

PURPOSE: SHORELINE STABILIZATION

DATUM: NAVD 88

ADJACENT OWNERS:

1. SEE ATTACHED LIST IN PERMIT PACKAGE.

AGENT: M.G. McLAREN, P.C.

131 W 35TH ST, 4TH FLR, NEW YORK, NY 10001

## PELHAM BAY LANDFILL

IN: EASTCHESTER BAY  
AT: BRONX AND PELHAM BAY PARKWAY  
COUNTY OF: BRONX STATE: NY

APPLICANT: NYC DEPARTMENT OF  
PARKS AND RECREATION  
117-02 ROOSEVELT AVENUE  
FLUSHING, NY 11368

EXISTING PARTIAL PLAN-  
STA 25+25 TO STA 28+50

02/17/2023

SHT 10 OF 30



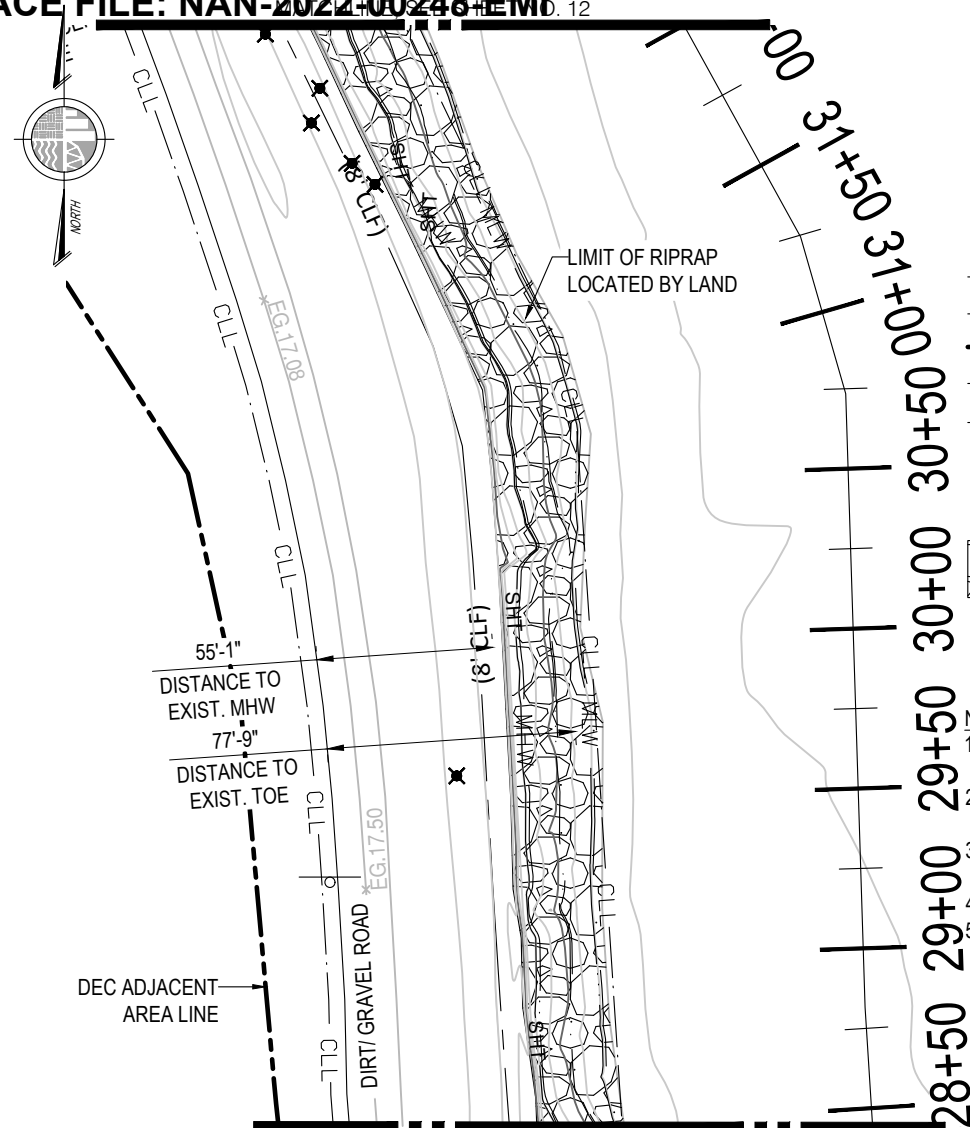

## LINETYPE LEGEND:

- MLW - - - - - MLW
- MHW - - - - - MHW
- SHT - - - - - SHT
- - - - - MAJOR CONTOUR
- - - - - MINOR CONTOUR
- (8' CLF) - - - - - 8' CHAIN LINK FENCE
- - - - - CLL - - - - - CONTRACTOR LIMIT LINES
- - - - - DEC ADJACENT AREA LINE
- - - - - SECURITY FENCE, SEE NOTE 4
- - - - - REFERENCE LINE
- ✕ - - - - - REMOVE TREE
- - - - - - SIGN
- - - - - - MONITORING WELL
- [Hatched Box] - - - - - RIPRAP

## NOTES:

1. THE SURVEY WAS COMPLETED BY MCLAREN ENGINEERING GROUP ON 03/18/2020.
2. VERTICAL DATUM IS FT NAVD88, HORIZONTAL DATUM IS NAD83 NY LONG ISLAND STATE PLANE.
3. FEDERAL NAVIGATION CHANNEL IS APPROXIMATELY 1,300 FT FROM THIS PROJECT SITE.
4. 63 TREES TO BE REMOVED.
5. DEC ADJACENT AREA LINE WAS OBTAINED BY COMBINING THE CURRENT CONTOUR AT EL 10' NAVD88, AND THE EL 10' CONTOUR IN 1966.

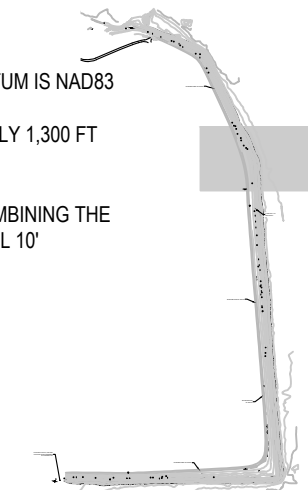

## KEY PLAN

## EXISTING PARTIAL PLAN- STA 28+50 TO STA 32+00

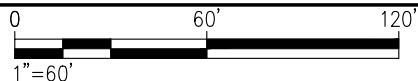

PURPOSE: SHORELINE STABILIZATION

DATUM: NAVD 88

ADJACENT OWNERS:

1. SEE ATTACHED LIST IN  
PERMIT PACKAGE.

AGENT: M.G. McLAREN, P.C.

131 W 35TH ST, 4TH FLR, NEW YORK, NY 10001

## PELHAM BAY LANDFILL

IN: EASTCHESTER BAY  
AT: BRONX AND PELHAM BAY PARKWAY  
COUNTY OF: BRONX STATE: NY

APPLICANT: NYC DEPARTMENT OF  
PARKS AND RECREATION  
117-02 ROOSEVELT AVENUE  
FLUSHING, NY 11368

EXISTING PARTIAL PLAN-  
STA 28+50 TO STA 32+00

02/17/2023

SHT 11 OF 30

\\nyddad01\Projects\Project60\60466.3\10\_Dwg\pelham bay landfill\CAUD\USACE\4-5 Existing Partial Plans.dwg PLOT TIME: Thu, 02 Mar 2023 - 9:51am LAST SAVE: Wed, 12 Jan 2022 - 4:56pm BY: jgonces

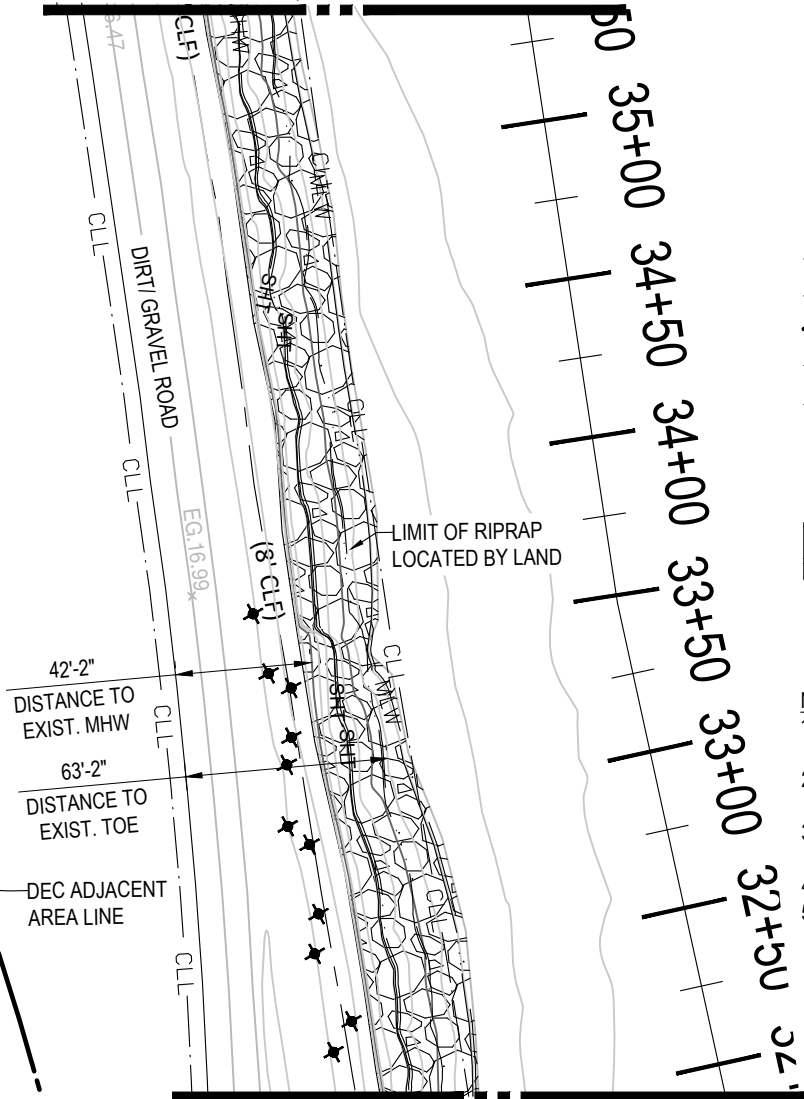

#### LINETYPE LEGEND:

- MLW - - - - - MLW
- MHW - - - - - MHW
- SHT - - - - - SHT
- MAJOR CONTOUR
- MINOR CONTOUR
- (8' CLF) - - - - - 8' CHAIN LINK FENCE
- CLL — CONTRACTOR LIMIT LINES
- DEC ADJACENT AREA LINE
- SECURITY FENCE, SEE NOTE 4
- REFERENCE LINE
- ✕ REMOVE TREE
- SIGN
- MONITORING WELL
- RIPRAP

#### NOTES:

1. THE SURVEY WAS COMPLETED BY MCLAREN ENGINEERING GROUP ON 03/18/2020.
2. VERTICAL DATUM IS FT NAVD88, HORIZONTAL DATUM IS NAD83 NY LONG ISLAND STATE PLANE.
3. FEDERAL NAVIGATION CHANNEL IS APPROXIMATELY 1,300 FT FROM THIS PROJECT SITE.
4. 63 TREES TO BE REMOVED.
5. DEC ADJACENT AREA LINE WAS OBTAINED BY COMBINING THE CURRENT CONTOUR AT EL 10' NAVD88, AND THE EL 10' CONTOUR IN 1966.

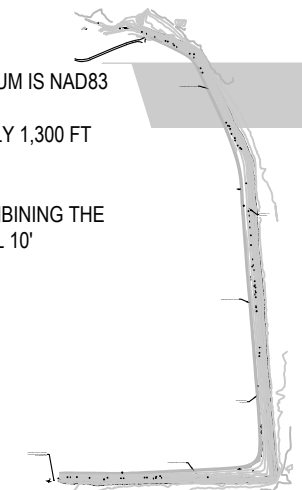

#### KEY PLAN

### EXISTING PARTIAL PLAN- STA 32+00 TO STA 35+25

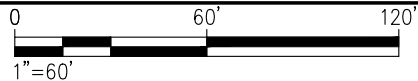

PURPOSE: SHORELINE STABILIZATION

DATUM: NAVD 88

ADJACENT OWNERS:

1. SEE ATTACHED LIST IN PERMIT PACKAGE.

AGENT: M.G. McLAREN, P.C.

131 W 35TH ST, 4TH FLR, NEW YORK, NY 10001

#### PELHAM BAY LANDFILL

IN: EASTCHESTER BAY  
AT: BRONX AND PELHAM BAY PARKWAY  
COUNTY OF: BRONX STATE: NY

APPLICANT: NYC DEPARTMENT OF  
PARKS AND RECREATION  
117-02 ROOSEVELT AVENUE  
FLUSHING, NY 11368

EXISTING PARTIAL PLAN-  
STA 32+00 TO STA 35+25

02/17/2023

SHT 12 OF 30

\\prod001\Projects\160466-3\10-Dwg\pelham bay landfill\CAUD\USACE\4-5 Existing Partial Plans.dwg PLOT TIME: Thu, 02 Mar 2023 - 9:51am LAST SAVE: Wed, 12 Jan 2022 - 4:52pm BY: jgonces

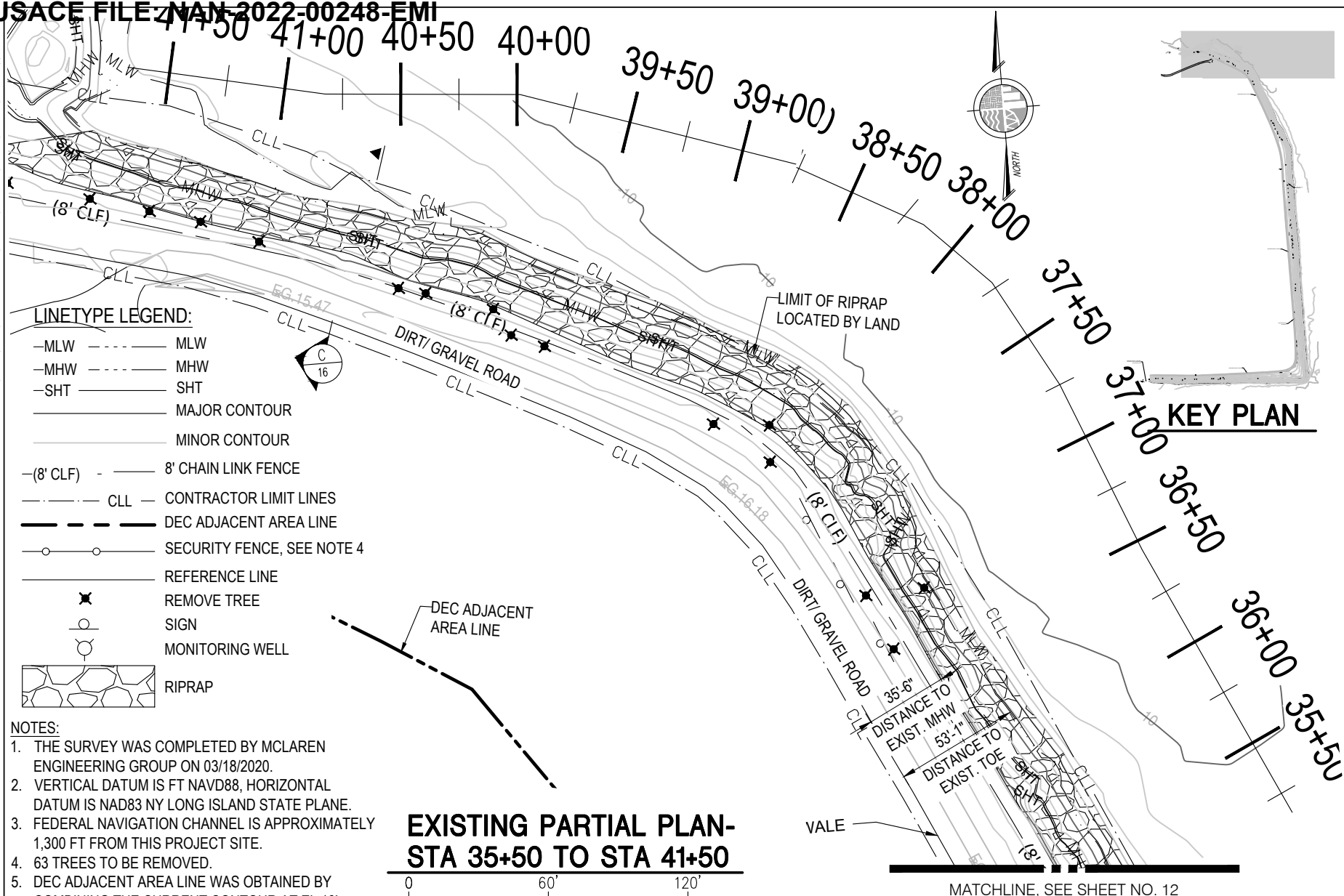

**LINETYPE LEGEND:**

- MLW - - - - - MLW
- MHW - - - - - MHW
- SHT - - - - - SHT
- - - - - MAJOR CONTOUR
- - - - - MINOR CONTOUR
- (8' CLF) - - - - - 8' CHAIN LINK FENCE
- - - - - CLL - CONTRACTOR LIMIT LINES
- - - - - DEC ADJACENT AREA LINE
- - - - - SECURITY FENCE, SEE NOTE 4
- - - - - REFERENCE LINE
- ✕ REMOVE TREE
- SIGN
- MONITORING WELL
- ▨ RIPRAP

**NOTES:**

1. THE SURVEY WAS COMPLETED BY McLAREN ENGINEERING GROUP ON 03/18/2020.
2. VERTICAL DATUM IS FT NAVD88, HORIZONTAL DATUM IS NAD83 NY LONG ISLAND STATE PLANE.
3. FEDERAL NAVIGATION CHANNEL IS APPROXIMATELY 1,300 FT FROM THIS PROJECT SITE.
4. 63 TREES TO BE REMOVED.
5. DEC ADJACENT AREA LINE WAS OBTAINED BY COMBINING THE CURRENT CONTOUR AT EL 10' NAVD88, AND THE EL 10' CONTOUR IN 1966.

**EXISTING PARTIAL PLAN-  
STA 35+50 TO STA 41+50**

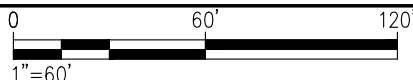

<p>PURPOSE: SHORELINE STABILIZATION                  DATUM: NAVD 88                  ADJACENT OWNERS:                  1. SEE ATTACHED LIST IN PERMIT PACKAGE.</p> <p>AGENT: M.G. McLAREN, P.C.                  131 W 35TH ST, 4TH FLR, NEW YORK, NY 10001</p>	<p>PELHAM BAY LANDFILL</p> <p>IN: EASTCHESTER BAY                  AT: BRONX AND PELHAM BAY PARKWAY                  COUNTY OF: BRONX STATE: NY</p> <p>APPLICANT: NYC DEPARTMENT OF PARKS AND RECREATION                  117-02 ROOSEVELT AVENUE                  FLUSHING, NY 11368</p>		<p>EXISTING PARTIAL PLAN-                  STA 35+25 TO STA 41+50</p> <p>02/17/2023</p> <p>SHT 13 OF 30</p>
---	---	--	---

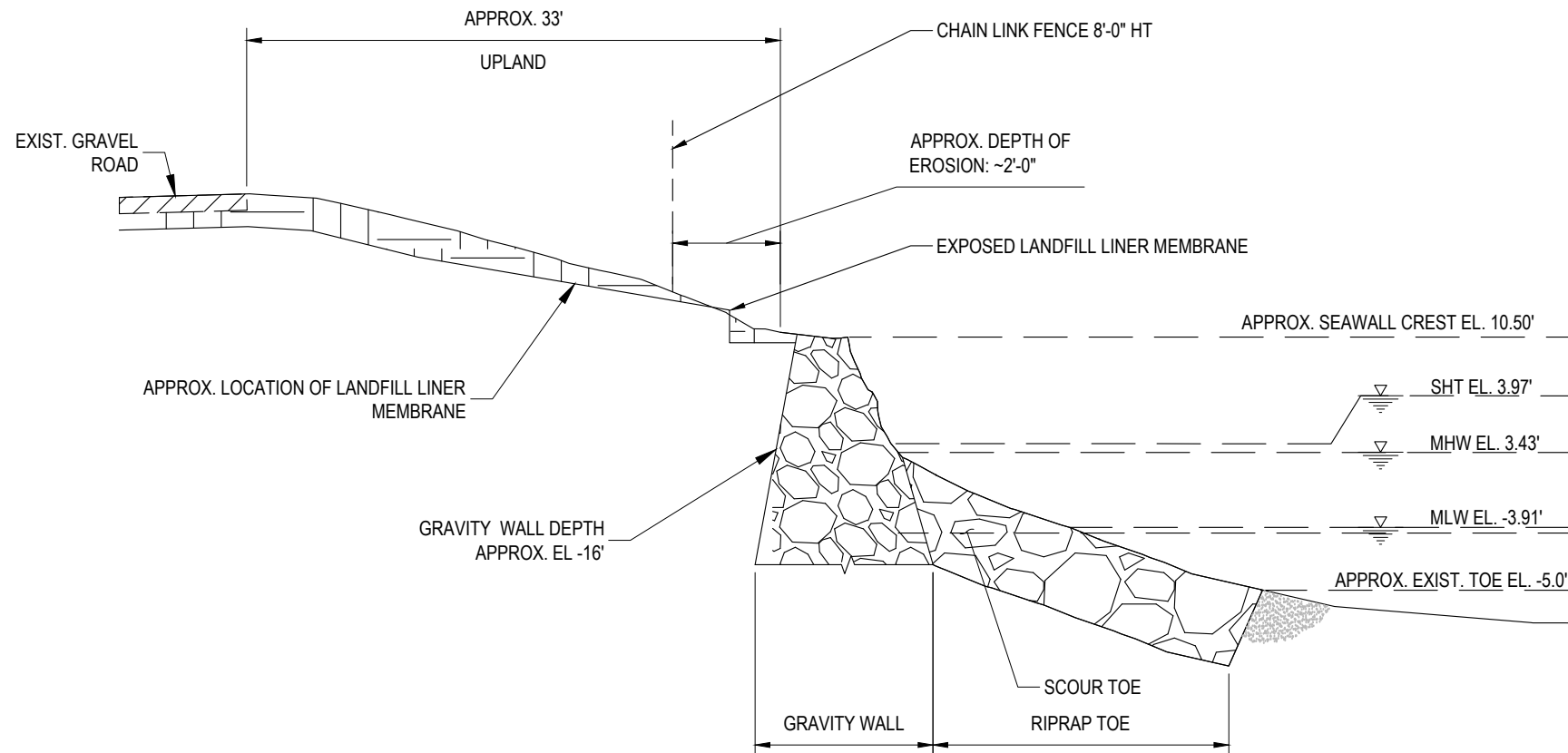

**A** **TYPICAL EXISTING SECTION - STA 7+00**

14  $\frac{3}{32}'' = 1'-0''$

## NOTE:

1. LINER LOCATION IS BASED ON TYPICAL DETAIL FROM AS-BUILT DRAWING OF SEAWALL. LINER MAY CHANGE THROUGHOUT THE PERIMETER OF THE SEAWALL.

PURPOSE: SHORELINE STABILIZATION

DATUM: NAVD 88

ADJACENT OWNERS:

1. SEE ATTACHED LIST IN PERMIT PACKAGE.

AGENT: M.G. McLAREN, P.C.

131 W 35TH ST, 4TH FLR, NEW YORK, NY 10001

## PELHAM BAY LANDFILL

IN: EASTCHESTER BAY  
AT: BRONX AND PELHAM BAY PARKWAY  
COUNTY OF: BRONX STATE: NY

APPLICANT: NYC DEPARTMENT OF  
PARKS AND RECREATION  
117-02 ROOSEVELT AVENUE  
FLUSHING, NY 11368

## EXISTING SECTIONS I

02/17/2023

SHT 14 OF 30

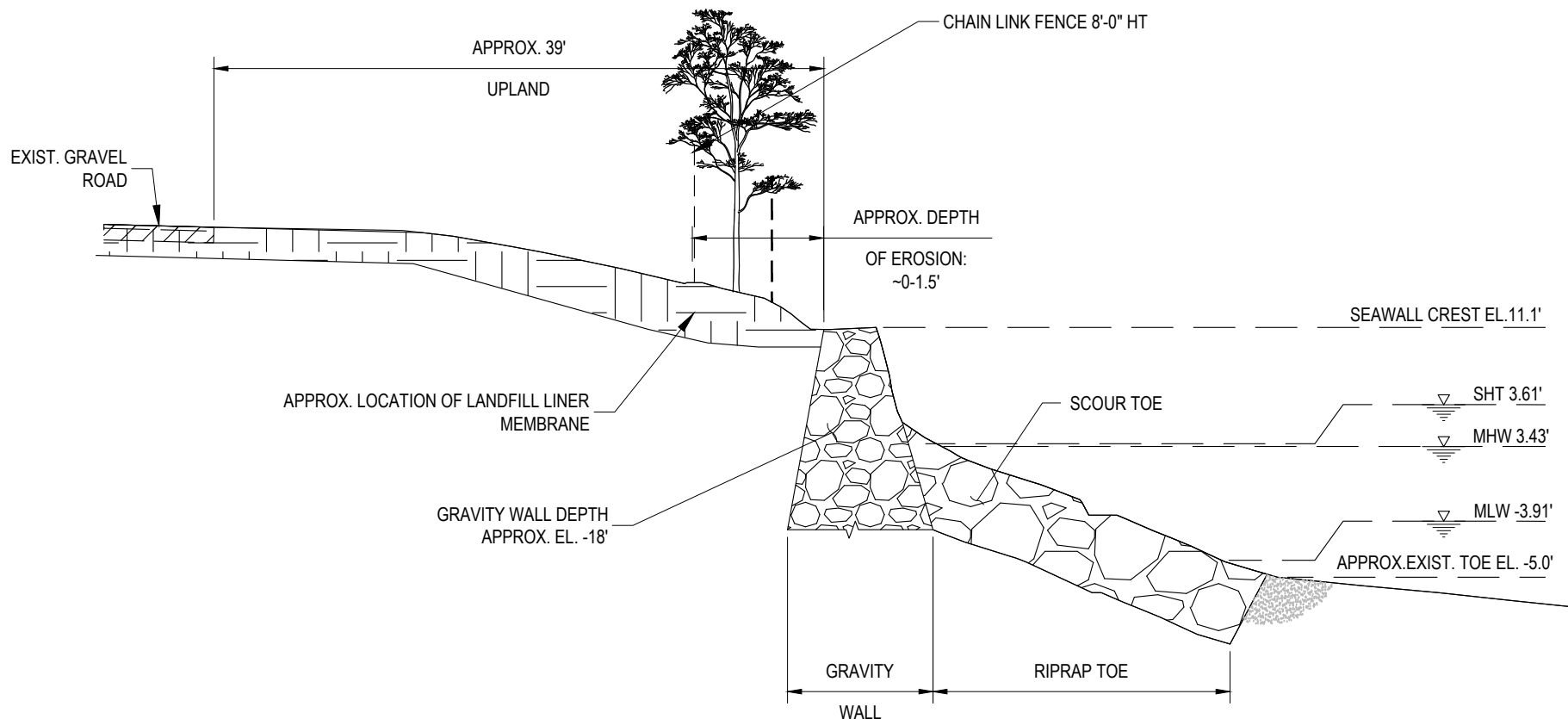

B

## TYPICAL EXISTING SECTION - STA 25+75

15

3/32" = 1'-0"

### NOTE:

1. LINER LOCATION IS BASED ON TYPICAL DETAIL FROM AS-BUILT DRAWING OF SEAWALL. LINER MAY CHANGE THROUGHOUT THE PERIMETER OF THE SEAWALL.

PURPOSE: SHORELINE STABILIZATION

DATUM: NAVD 88

ADJACENT OWNERS:

1. SEE ATTACHED LIST IN PERMIT PACKAGE.

AGENT: M.G. McLAREN, P.C.

131 W 35TH ST, 4TH FLR, NEW YORK, NY 10001

## PELHAM BAY LANDFILL

IN: EASTCHESTER BAY  
AT: BRONX AND PELHAM BAY PARKWAY  
COUNTY OF: BRONX STATE: NY

APPLICANT: NYC DEPARTMENT OF  
PARKS AND RECREATION  
117-02 ROOSEVELT AVENUE  
FLUSHING, NY 11368

## EXISTING SECTIONS II

02/17/2023

SHT 15 OF 30

\\nyddad\Projects\160466.3\10 Drawings\pelham bay landfill\CADD\USACE-6-7 Existing Sections.dwg PLOT TIME: Thu, 02 Mar 2023 - 9:53am LAST SAVE: Wed, 12 Jan 2022 - 4:57pm BY: jgrees

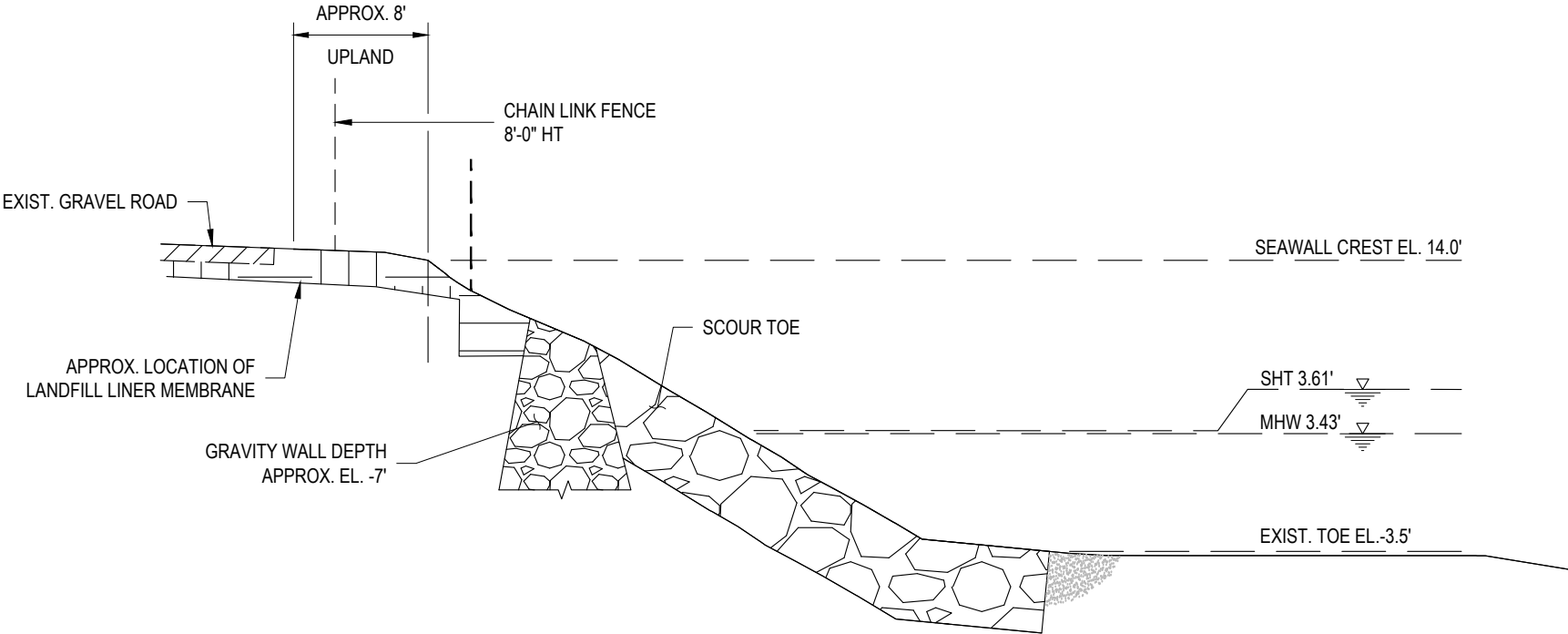

C

16

TYPICAL EXISTING SECTION - STA 40+50

3/32" = 1'-0"

NOTE:  
1. LINER LOCATION IS BASED ON TYPICAL DETAIL FROM AS-BUILT DRAWING OF SEAWALL. LINER MAY CHANGE THROUGHOUT THE PERIMETER OF THE SEAWALL.

PURPOSE: SHORELINE STABILIZATION DATUM: NAVD 88 ADJACENT OWNERS: 1. SEE ATTACHED LIST IN PERMIT PACKAGE.  AGENT: M.G. McLAREN, P.C. 131 W 35TH ST, 4TH FLR, NEW YORK, NY 10001	PELHAM BAY LANDFILL		EXISTING SECTIONS III
	IN: EASTCHESTER BAY AT: BRONX AND PELHAM BAY PARKWAY COUNTY OF: BRONX STATE: NY	APPLICANT: NYC DEPARTMENT OF PARKS AND RECREATION 117-02 ROOSEVELT AVENUE FLUSHING, NY 11368	02/17/2023  SHT 16 OF 30

FILE NAME: \\nyddad\Projects\Project60\60466-3\10.Dwg\pelham bay landfill\CADD\USACE-6-7 Existing Sections.dwg PLOT TIME: Thu, 02 Mar 2023 - 9:53am LAST SAVE: Wed, 12 Jan 2022 - 4:57pm BY: jgrees

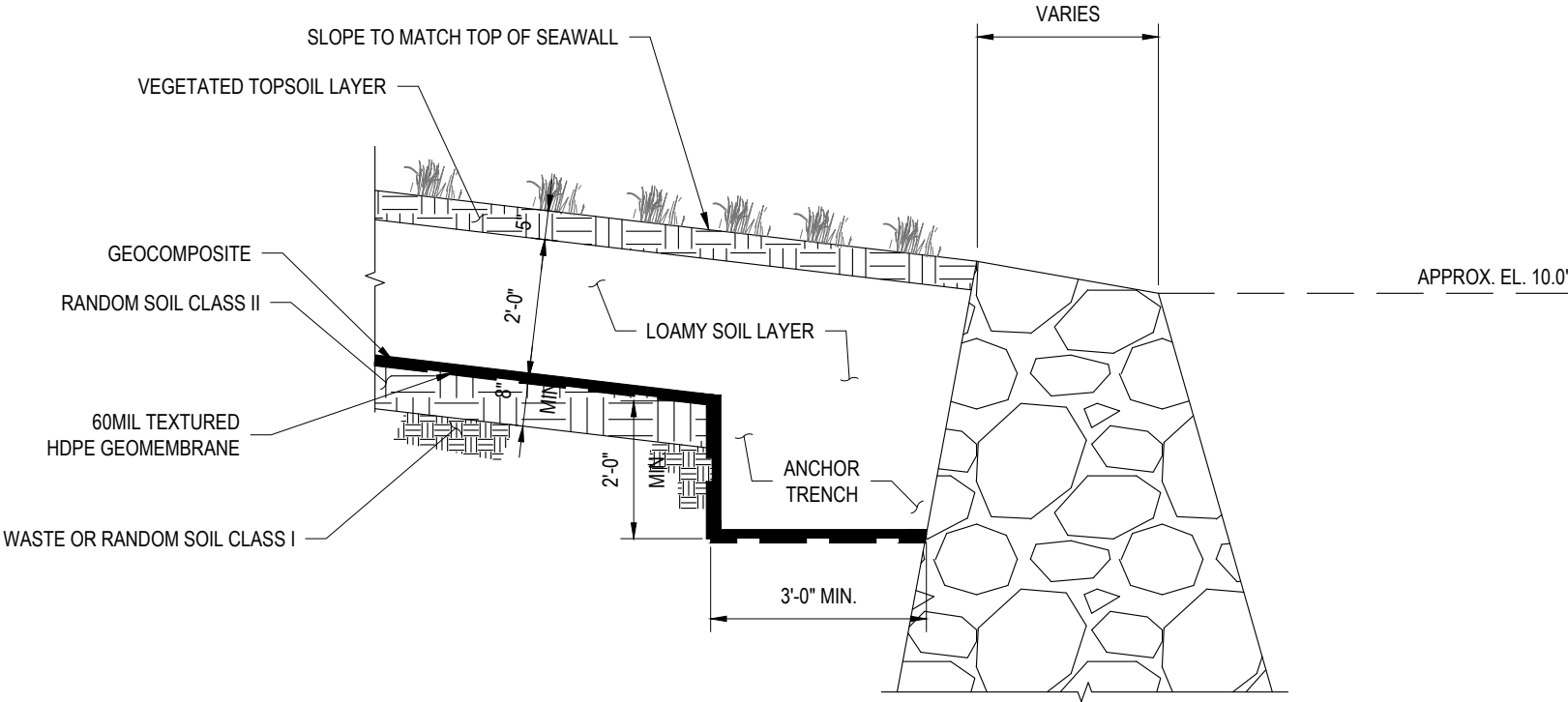

**D** TYPICAL DEP SEAWALL SECTION

NOTE:  
1. LINER LOCATION IS BASED ON TYPICAL DETAIL FROM AS-BUILT DRAWING OF SEAWALL. LINER MAY CHANGE THROUGHOUT THE PERIMETER OF THE SEAWALL.

PURPOSE: SHORELINE STABILIZATION DATUM: NAVD 88 ADJACENT OWNERS: 1. SEE ATTACHED LIST IN PERMIT PACKAGE.  AGENT: M.G. McLAREN, P.C. 131 W 35TH ST, 4TH FLR, NEW YORK, NY 10001	PELHAM BAY LANDFILL		EXISTING SECTIONS IV
	IN: EASTCHESTER BAY AT: BRONX AND PELHAM BAY PARKWAY COUNTY OF: BRONX STATE: NY	APPLICANT: NYC DEPARTMENT OF PARKS AND RECREATION 117-02 ROOSEVELT AVENUE FLUSHING, NY 11368	02/17/2023  SHT 17 OF 30

PROJECT NAME: \\nydoo\projects\proj60160466\_31\0\_Dwg\pelham bay landfill\CA00\USACE\18- Proposed Partial Plans.dwg PLOT TIME: Thu, 02 Mar 2023 - 9:57am LAST SAVE: Thu, 02 Mar 2023 - 9:53am BY: jorces

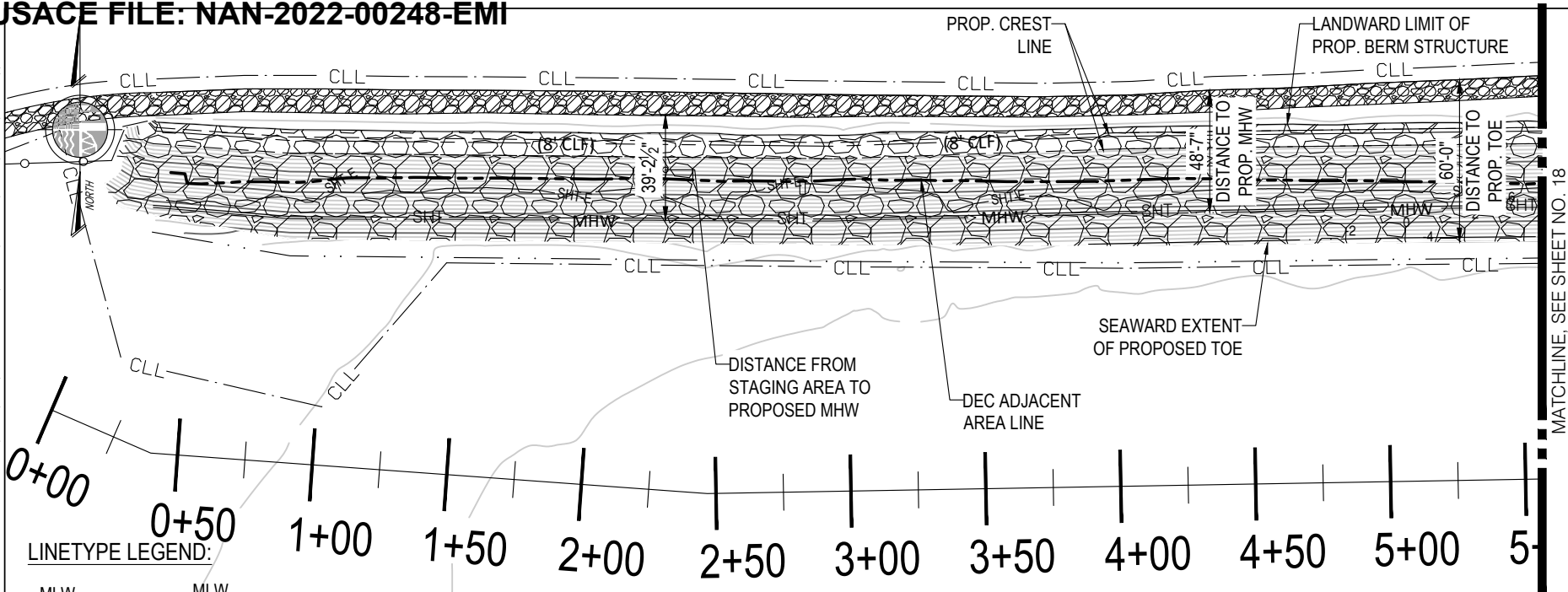

- LINETYPE LEGEND:**
- MLW - - - - - MLW
  - MHW - - - - - MHW
  - SHT - - - - - SHT
  - SHT-E - - - - - EXISTING SHT
  - - - - - MAJOR CONTOUR
  - - - - - MINOR CONTOUR
  - (8' CLF) - - - - - NEW 8' CHAIN LINK FENCE
  - - - - - CLL - CONTRACTOR LIMIT LINES
  - - - - - TURBIDITY CURTAIN
  - - - - - DEC ADJACENT AREA LINE
  - - - - - SECURITY FENCE, SEE NOTE 4
  - - - - - REFERENCE LINE
  - [Pattern] PROPOSED BERM
  - [Pattern] TEMPORARY GRAVEL ROADWAY

**PROPOSED PARTIAL PLAN  
- STA 0+00 TO STA 5+50**

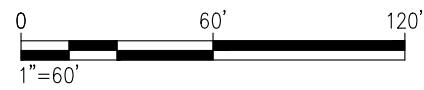

- NOTES:**
1. THE SURVEY WAS COMPLETED BY MCLAREN ENGINEERING GROUP ON 03/18/2020.
  2. VERTICAL DATUM IS FT NAVD88, HORIZONTAL DATUM IS NAD83 NY LONG ISLAND STATE PLANE.
  3. NEW RIPRAP WILL BE GRADED INTO EXISTING RIPRAP AT TRANSITION AREAS.
  4. LEE SIDE EDGE OF BERM TO MATCH EXISTING GRADE.
  5. FENCE TO BE RELOCATED TO APPROXIMATE CENTERLINE OF BERM CREST.
  6. FEDERAL NAVIGATION CHANNEL IS APPROXIMATELY 1,300 FT FROM THIS PROJECT SITE.
  7. CONSTRUCTION IS TO TAKE PLACE FROM THE SHORELINE.
  8. THE PROPOSED RIPRAP WILL INTRODUCE 8044 CY OF FILL VOLUME BELOW SHT-E AND 84,358 SQUARE FEET OF FILL AREA BELOW SHT-E.

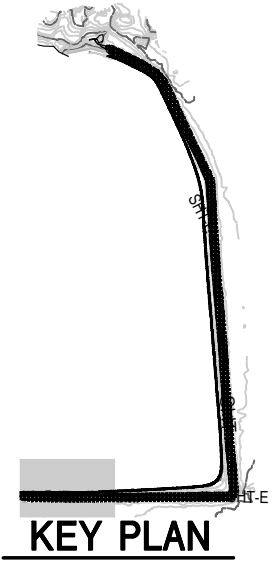

<p>PURPOSE: SHORELINE STABILIZATION                  DATUM: NAVD 88                  ADJACENT OWNERS:                  1. SEE ATTACHED LIST IN PERMIT PACKAGE.</p> <p>AGENT: M.G. McLAREN, P.C.                  131 W 35TH ST, 4TH FLR, NEW YORK, NY 10001</p>	<p style="text-align: center;">PELHAM BAY LANDFILL</p> <p>IN: EASTCHESTER BAY                  AT: BRONX AND PELHAM BAY PARKWAY                  COUNTY OF: BRONX STATE: NY</p> <p>APPLICANT: NYC DEPARTMENT OF PARKS AND RECREATION                  117-02 ROOSEVELT AVENUE                  FLUSHING, NY 11368</p>	<p>PROPOSED PARTIAL PLAN - STA 0+00 TO STA 5+50</p> <p>02/17/2023</p> <p>SHT 18 OF 30</p>
---	---	---



\\nydof\projects\proj60\60466-3\10.Dwg\pelham bay landfill\CA00\USACE\18- Proposed Partial Plans.dwg PLOT TIME: Thu, 02 Mar 2023 - 9:57am LAST SAVE: Thu, 02 Mar 2023 - 9:53am BY: jances

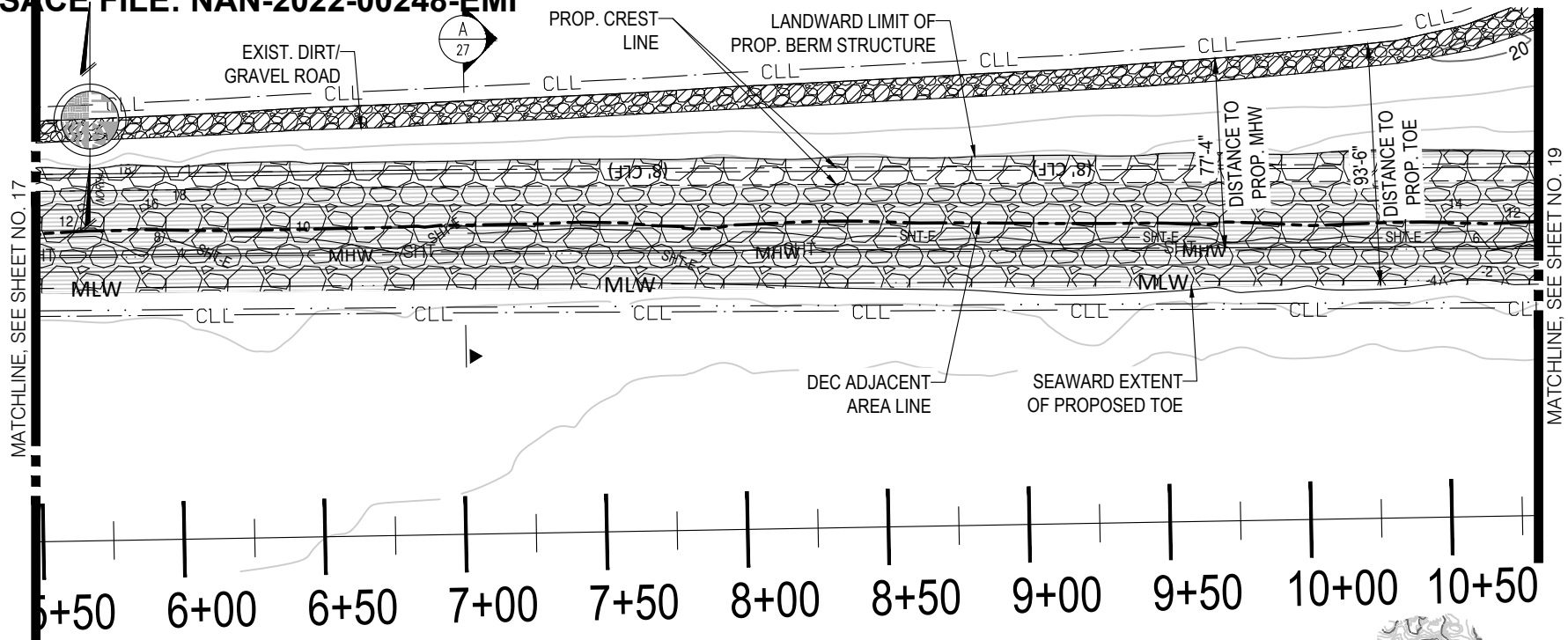

**LINETYPE LEGEND:**

- MLW - - - - - MLW
- MHW - - - - - MHW
- SHT - - - - - SHT
- SHT-E - - - - - EXISTING SHT
- - - - - MAJOR CONTOUR
- - - - - MINOR CONTOUR
- (8' CLF) - - - - - NEW 8' CHAIN LINK FENCE
- - - - - CLL - CONTRACTOR LIMIT LINES
- - - - - TURBIDITY CURTAIN
- - - - - DEC ADJACENT AREA LINE

- - - - - REFERENCE LINE
- PROPOSED BERM
- TEMPORARY GRAVEL ROADWAY

**PROPOSED PARTIAL PLAN-  
STA 5+50 TO STA 10+75**

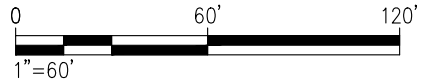

- NOTES:**
1. THE SURVEY WAS COMPLETED BY MCLAREN ENGINEERING GROUP ON 03/18/2020.
  2. VERTICAL DATUM IS FT NAVD88, HORIZONTAL DATUM IS NAVD88 NY LONG ISLAND STATE PLANE.
  3. FEDERAL NAVIGATION CHANNEL IS APPROXIMATELY 1,300 FT FROM THIS PROJECT SITE.
  4. CONSTRUCTION IS TO TAKE PLACE FROM THE SHORELINE, NOT THE WATER.
  5. THE PROPOSED RIPRAP WILL INTRODUCE 8044 CY OF FILL VOLUME BELOW SHT-E AND 84,358 SQUARE FEET OF FILL AREA BELOW SHT-E.

**KEY PLAN**

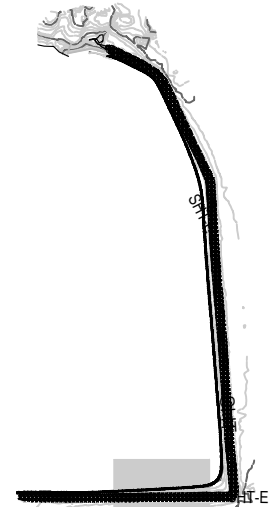

<p>PURPOSE: SHORELINE STABILIZATION                  DATUM: NAVD 88                  ADJACENT OWNERS:                  1. SEE ATTACHED LIST IN PERMIT PACKAGE.</p> <p>AGENT: M.G. McLAREN, P.C.                  131 W 35TH ST, 4TH FLR, NEW YORK, NY 10001</p>	<p style="text-align: center;">PELHAM BAY LANDFILL</p> <p>IN: EASTCHESTER BAY                  AT: BRONX AND PELHAM BAY PARKWAY                  COUNTY OF: BRONX STATE: NY</p> <p>APPLICANT: NYC DEPARTMENT OF PARKS AND RECREATION                  117-02 ROOSEVELT AVENUE                  FLUSHING, NY 11368</p>	<p>PROPOSED PARTIAL PLAN - STA 5+50 TO STA 10+75</p> <p>02/17/2023</p> <p>SHT 19 OF 30</p>
---	---	--

\\prod001\projects\proj601\60406-3\10-Dwg\pelham bay landfill\CAUD\USACE\18-Proposed Partial Plans.dwg PLOT TIME: Thu, 02 Mar 2023 - 9:36am LAST SAVE: Thu, 02 Mar 2023 - 9:35am BY: jgrees

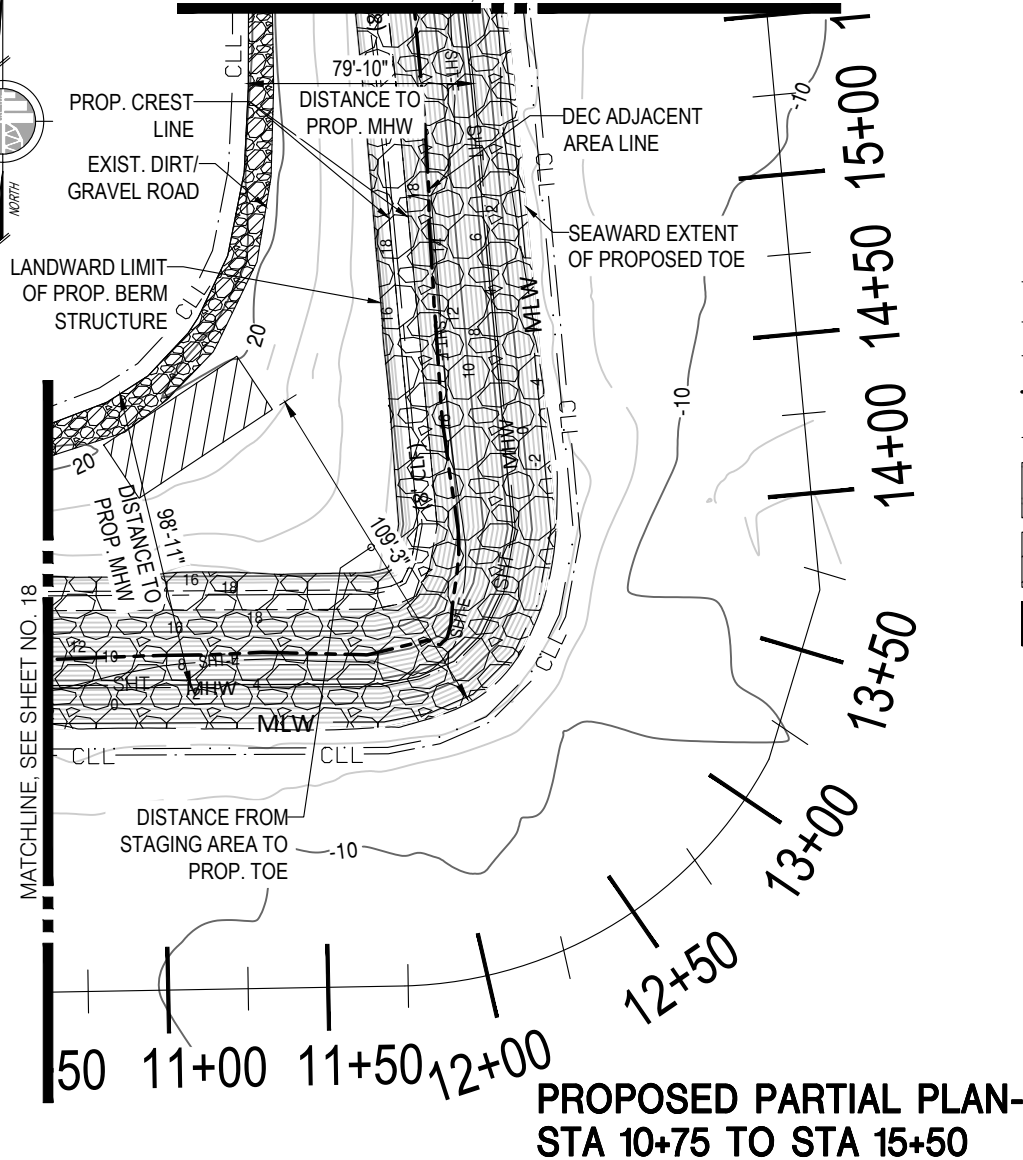

# LINETYPE LEGEND:

—MLW	-----	MLW
—MHW	-----	MHW
—SHT	-----	SHT
—SHT-E	-----	EXISTING SHT
	-----	MAJOR CONTOUR
	-----	MINOR CONTOUR
—(8' CLF)	-----	NEW 8' CHAIN LINK FENCE
—CLL	-----	CONTRACTOR LIMIT LINES
	-----	TURBIDITY CURTAIN
—	-----	DEC ADJACENT AREA LINE
	-----	REFERENCE LINE
		PROPOSED BERM
		STAGING AREA
		TEMPORARY GRAVEL ROADWAY

## NOTES:

1. THE SURVEY WAS COMPLETED BY MCLAREN ENGINEERING GROUP ON 03/18/2020.
2. VERTICAL DATUM IS FT NAVD88, HORIZONTAL DATUM IS NAVD88 NY LONG ISLAND STATE PLANE.
3. FEDERAL NAVIGATION CHANNEL IS APPROXIMATELY 1,300 FT FROM THIS PROJECT SITE.
4. CONSTRUCTION IS TO TAKE PLACE FROM THE SHORELINE, NOT THE WATER.
5. THE PROPOSED RIPRAP WILL INTRODUCE 8044 CY OF FILL VOLUME BELOW SHT-E AND 84,358 SQUARE FEET OF FILL AREA BELOW SHT-E.

## KEY PLAN

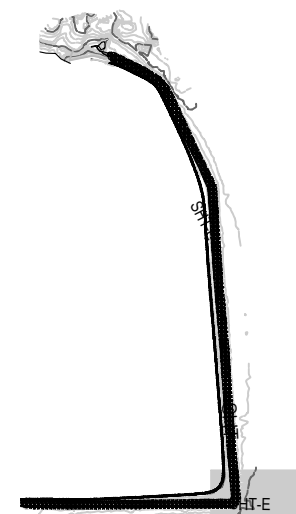

PURPOSE: SHORELINE STABILIZATION

DATUM: NAVD 88

ADJACENT OWNERS:

1. SEE ATTACHED LIST IN PERMIT PACKAGE.

AGENT: M.G. McLAREN, P.C.

131 W 35TH ST, 4TH FLR, NEW YORK, NY 10001

PELHAM BAY LANDFILL

IN: EASTCHESTER BAY  
AT: BRONX AND PELHAM BAY PARKWAY  
COUNTY OF: BRONX STATE: NY

APPLICANT: NYC DEPARTMENT OF  
PARKS AND RECREATION  
117-02 ROOSEVELT AVENUE  
FLUSHING, NY 11368

PROPOSED PARTIAL PLAN-  
STA 10+75 TO STA 15+50

02/17/2023

SHT 20 OF 30



LANDWARD LIMIT  
OF PROP. BERM  
STRUCTURE

EXIST. DIRT/  
GRAVEL ROAD

PROP. CREST  
LINE

CLL

CLL

CLL

CLL

DISTANCE TO  
PROP. MHW  
60'-6"

DISTANCE TO  
PROP. TOE  
75'-2"

DEC ADJACENT  
AREA LINE

SEAWARD EXTENT  
OF PROPOSED TOE

MATCHLINE, SEE SHEET NO. 19

15+50 16+00 16+50 17+00 17+50 18+00 18+50

### LINETYPE LEGEND:

- MLW - - - - - MLW
- MHW - - - - - MHW
- SHT - - - - - SHT
- SHT-E - - - - - EXISTING SHT
- - - - - MAJOR CONTOUR
- - - - - MINOR CONTOUR
- (8' CLF) - - - - - NEW 8' CHAIN LINK FENCE
- - - - - CLL - CONTRACTOR LIMIT LINES
- - - - - TURBIDITY CURTAIN
- - - - - DEC ADJACENT AREA LINE
- - - - - REFERENCE LINE



PROPOSED BERM



TEMPORARY GRAVEL  
ROADWAY

### NOTES:

1. THE SURVEY WAS COMPLETED BY MCLAREN ENGINEERING GROUP ON 03/18/2020.
2. VERTICAL DATUM IS FT NAVD88, HORIZONTAL DATUM IS NAVD88 NY LONG ISLAND STATE PLANE.
3. FEDERAL NAVIGATION CHANNEL IS APPROXIMATELY 1,300 FT FROM THIS PROJECT SITE.
4. CONSTRUCTION IS TO TAKE PLACE FROM THE SHORELINE, NOT THE WATER.
5. THE PROPOSED RIPRAP WILL INTRODUCE 8044 CY OF FILL VOLUME BELOW SHT-E AND 84,358 SQUARE FEET OF FILL AREA BELOW SHT-E.

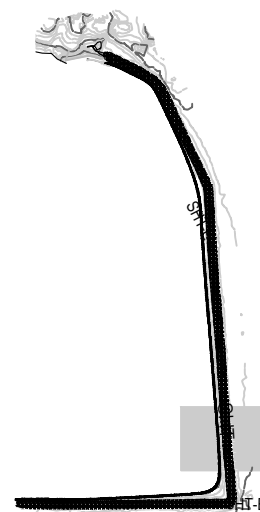

### KEY PLAN

## PROPOSED PARTIAL PLAN- STA 15+50 TO STA 18+75

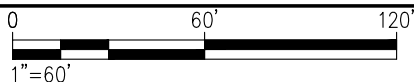

PURPOSE: SHORELINE STABILIZATION

DATUM: NAVD 88

ADJACENT OWNERS:

1. SEE ATTACHED LIST IN PERMIT PACKAGE.

AGENT: M.G. McLAREN, P.C.

131 W 35TH ST, 4TH FLR, NEW YORK, NY 10001

### PELHAM BAY LANDFILL

IN: EASTCHESTER BAY  
AT: BRONX AND PELHAM BAY PARKWAY  
COUNTY OF: BRONX STATE: NY

APPLICANT: NYC DEPARTMENT OF  
PARKS AND RECREATION  
117-02 ROOSEVELT AVENUE  
FLUSHING, NY 11368

PROPOSED PARTIAL PLAN-  
STA 15+50 TO STA 18+75

02/17/2023

SHT 21 OF 30

\\nyddad\projects\proj601\60466.3\10.Dwg\pelham bay landfill\CAUD\USACE\18- Proposed Partial Plans.dwg PLOT TIME: Thu, 02 Mar 2023 - 9:36am LAST SAVE: Thu, 02 Mar 2023 - 9:33am BY: jorces

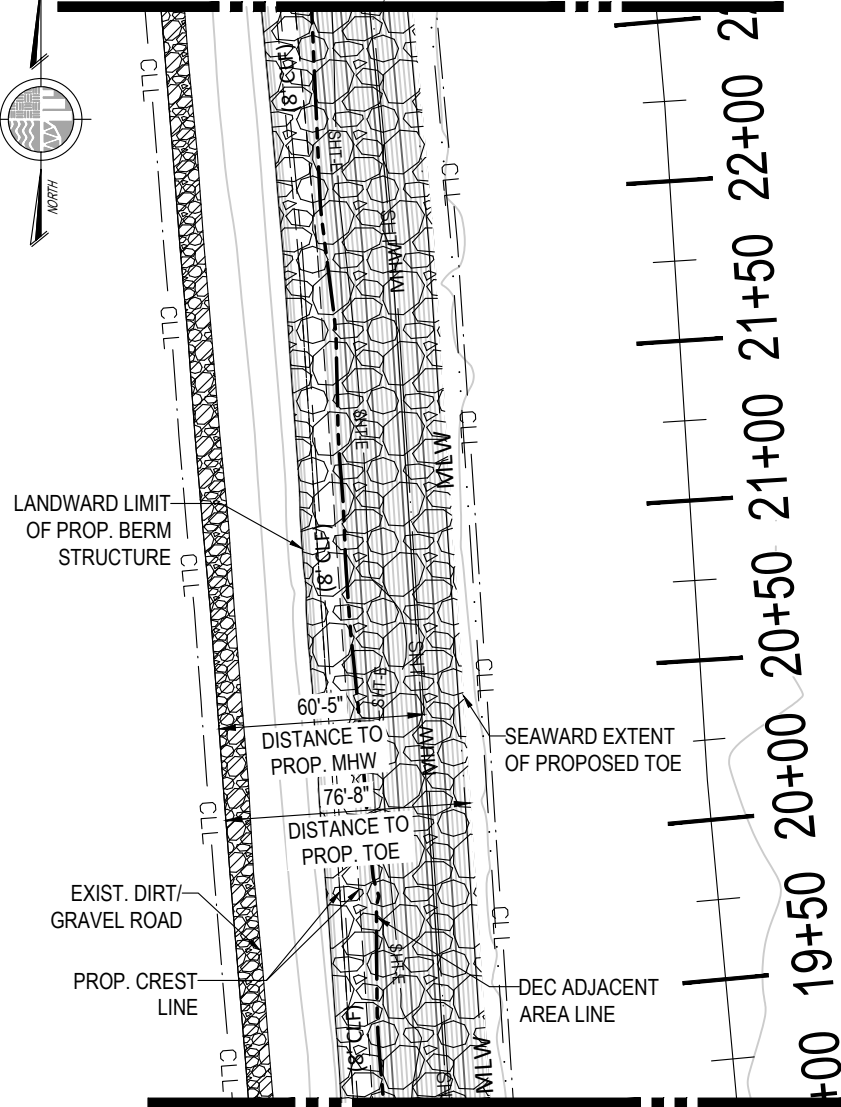

## PROPOSED PARTIAL PLAN- STA 18+75 TO STA 22+00

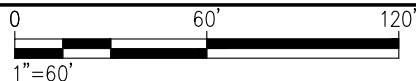

### LINETYPE LEGEND:

- MLW - - - - - MLW
- MHW - - - - - MHW
- SHT - - - - - SHT
- SHT-E - - - - - EXISTING SHT
- - - - - MAJOR CONTOUR
- - - - - MINOR CONTOUR
- (8' CLF) - - - - - NEW 8' CHAIN LINK FENCE
- - - - - CL - - - - - CONTRACTOR LIMIT LINES
- - - - - TURBIDITY CURTAIN
- - - - - DEC ADJACENT AREA LINE
- - - - - REFERENCE LINE



PROPOSED BERM



TEMPORARY GRAVEL ROADWAY

### NOTES:

1. THE SURVEY WAS COMPLETED BY MCLAREN ENGINEERING GROUP ON 03/18/2020.
2. VERTICAL DATUM IS FT NAVD88, HORIZONTAL DATUM IS NAVD88 NY LONG ISLAND STATE PLANE.
3. FEDERAL NAVIGATION CHANNEL IS APPROXIMATELY 1,300 FT FROM THIS PROJECT SITE.
4. CONSTRUCTION IS TO TAKE PLACE FROM THE SHORELINE, NOT THE WATER.
5. THE PROPOSED RIPRAP WILL INTRODUCE 8044 CY OF FILL VOLUME BELOW SHT-E AND 84,358 SQUARE FEET OF FILL AREA BELOW SHT-E.

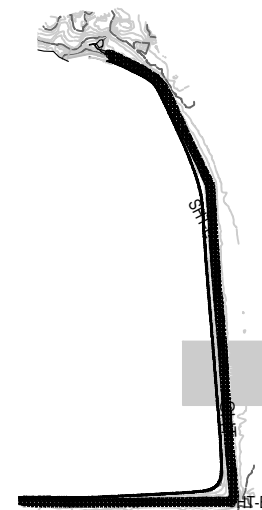

### KEY PLAN

PURPOSE: SHORELINE STABILIZATION

DATUM: NAVD 88

ADJACENT OWNERS:

1. SEE ATTACHED LIST IN PERMIT PACKAGE.

AGENT: M.G. McLAREN, P.C.

131 W 35TH ST, 4TH FLR, NEW YORK, NY 10001

### PELHAM BAY LANDFILL

IN: EASTCHESTER BAY  
AT: BRONX AND PELHAM BAY PARKWAY  
COUNTY OF: BRONX STATE: NY

APPLICANT: NYC DEPARTMENT OF  
PARKS AND RECREATION  
117-02 ROOSEVELT AVENUE  
FLUSHING, NY 11368

PROPOSED PARTIAL PLAN-  
STA 18+75 TO STA 22+00

02/17/2023

SHT 22 OF 30

\\nyddcd\projects\proj601\60466-3\10-Dwg\pelham bay landfill\CAAD\USACE\18-Proposed Partial Plans.dwg PLOT TIME: Thu, 02 Mar 2023 - 9:59am LAST SAVE: Thu, 02 Mar 2023 - 9:53am BY: jorces



LANDWARD LIMIT  
OF PROP. BERM  
STRUCTURE

EXIST. DIRT/  
GRAVEL ROAD

PROP. CREST  
LINE

DEC ADJACENT  
AREA LINE

SEAWARD EXTENT  
OF PROPOSED TOE

DISTANCE TO  
PROP. MHW  
65'-5"



DISTANCE TO  
PROP. TOE  
77'-8"

MATCHLINE, SEE SHEET NO. 21

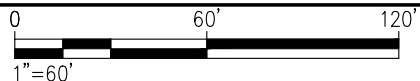
## PROPOSED PARTIAL PLAN- STA 22+00 TO STA 25+25



### LINETYPE LEGEND:

- MLW - - - - - MLW
- MHW - - - - - MHW
- SHT - - - - - SHT
- SHT-E - - - - - EXISTING SHT
- - - - - MAJOR CONTOUR
- - - - - MINOR CONTOUR
- (8' CLF) - - - - - NEW 8' CHAIN LINK FENCE
- - - - - CLL - CONTRACTOR LIMIT LINES
- - - - - TURBIDITY CURTAIN
- - - - - DEC ADJACENT AREA LINE
- - - - - REFERENCE LINE
-  PROPOSED BERM
-  TEMPORARY GRAVEL ROADWAY

### NOTES:

1. THE SURVEY WAS COMPLETED BY MCLAREN ENGINEERING GROUP ON 03/18/2020.
2. VERTICAL DATUM IS FT NAVD88, HORIZONTAL DATUM IS NAVD88 NY LONG ISLAND STATE PLANE.
3. FEDERAL NAVIGATION CHANNEL IS APPROXIMATELY 1,300 FT FROM THIS PROJECT SITE.
4. CONSTRUCTION IS TO TAKE PLACE FROM THE SHORELINE, NOT THE WATER.
5. THE PROPOSED RIPRAP WILL INTRODUCE 8044 CY OF FILL VOLUME BELOW SHT-E AND 84,358 SQUARE FEET OF FILL AREA BELOW SHT-E.

### KEY PLAN

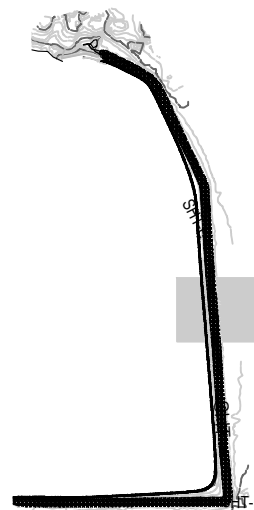

PURPOSE: SHORELINE STABILIZATION

DATUM: NAVD 88

ADJACENT OWNERS:

1. SEE ATTACHED LIST IN PERMIT PACKAGE.

AGENT: M.G. McLAREN, P.C.

131 W 35TH ST, 4TH FLR, NEW YORK, NY 10001

### PELHAM BAY LANDFILL

IN: EASTCHESTER BAY  
AT: BRONX AND PELHAM BAY PARKWAY  
COUNTY OF: BRONX STATE: NY

APPLICANT: NYC DEPARTMENT OF  
PARKS AND RECREATION  
117-02 ROOSEVELT AVENUE  
FLUSHING, NY 11368

PROPOSED PARTIAL PLAN-  
STA 22+00 TO STA 25+25

02/17/2023

SHT 23 OF 30

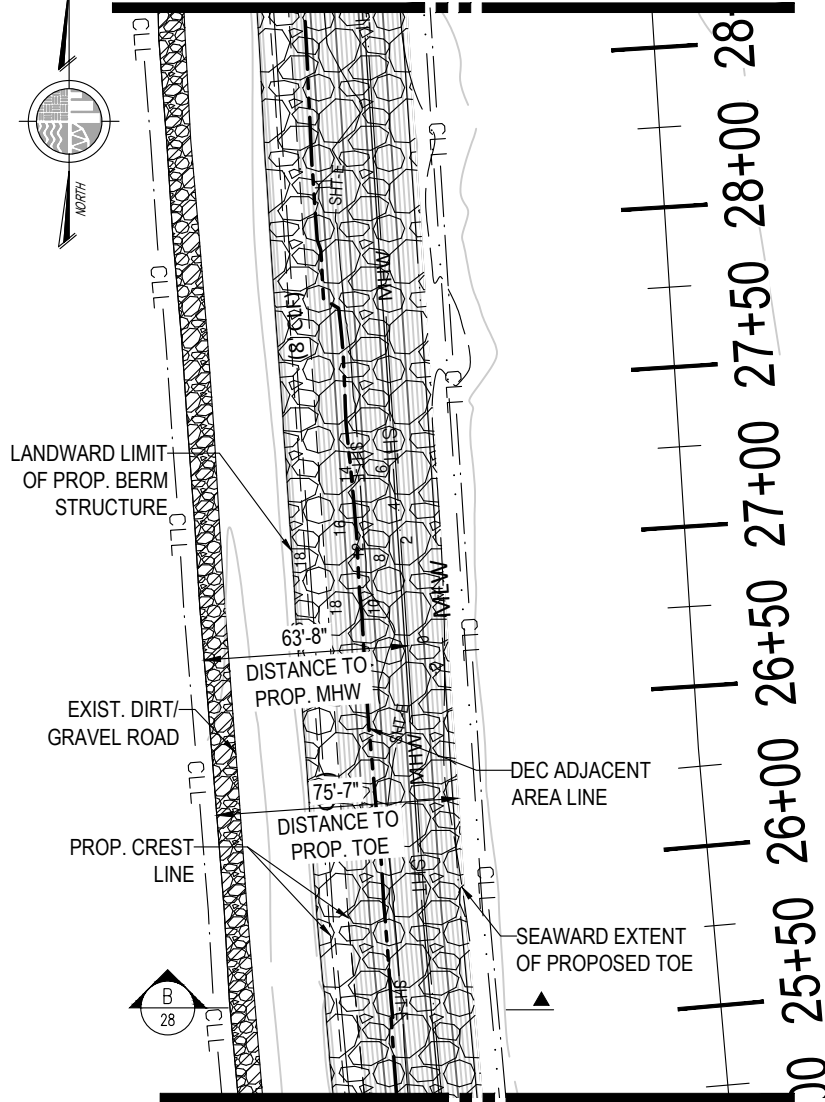

# LINETYPE LEGEND:

- MLW - - - - - MLW
- MHW - - - - - MHW
- SHT - - - - - SHT
- SHT-E - - - - - EXISTING SHT
- - - - - MAJOR CONTOUR
- - - - - MINOR CONTOUR
- (8' CLF) - - - - - NEW 8' CHAIN LINK FENCE
- - - - - CLL - CONTRACTOR LIMIT LINES
- - - - - TURBIDITY CURTAIN
- - - - - DEC ADJACENT AREA LINE
- - - - - REFERENCE LINE
- [Pattern] PROPOSED BERM
- [Pattern] TEMPORARY GRAVEL ROADWAY

## NOTES:

1. THE SURVEY WAS COMPLETED BY MCLAREN ENGINEERING GROUP ON 03/18/2020.
2. VERTICAL DATUM IS FT NAVD88, HORIZONTAL DATUM IS NAVD88 NY LONG ISLAND STATE PLANE.
3. FEDERAL NAVIGATION CHANNEL IS APPROXIMATELY 1,300 FT FROM THIS PROJECT SITE.
4. CONSTRUCTION IS TO TAKE PLACE FROM THE SHORELINE, NOT THE WATER.
5. THE PROPOSED RIPRAP WILL INTRODUCE 8044 CY OF FILL VOLUME BELOW SHT-E AND 84,358 SQUARE FEET OF FILL AREA BELOW SHT-E.



## KEY PLAN

## PROPOSED PARTIAL PLAN- STA 25+25 TO STA 28+50

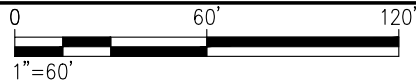

PURPOSE: SHORELINE STABILIZATION

DATUM: NAVD 88

ADJACENT OWNERS:

1. SEE ATTACHED LIST IN PERMIT PACKAGE.

AGENT: M.G. McLAREN, P.C.

131 W 35TH ST, 4TH FLR, NEW YORK, NY 10001

## PELHAM BAY LANDFILL

IN: EASTCHESTER BAY  
AT: BRONX AND PELHAM BAY PARKWAY  
COUNTY OF: BRONX STATE: NY

APPLICANT: NYC DEPARTMENT OF  
PARKS AND RECREATION  
117-02 ROOSEVELT AVENUE  
FLUSHING, NY 11368

PROPOSED PARTIAL PLAN-  
STA 25+25 TO STA 28+50

02/17/2023

SHT 24 OF 30



LANDWARD LIMIT  
OF PROP. BERM  
STRUCTURE

EXIST. DIRT/  
GRAVEL ROAD

PROP. CREST  
LINE

DISTANCE FROM  
STAGING AREA TO  
PROPOSED MHW

DEC ADJACENT  
AREA LINE

63'-0"  
DISTANCE TO  
PROP. MHW  
77'-0"  
DISTANCE TO  
PROP. TOE

SEAWARD EXTENT  
OF PROPOSED TOE

MATCHLINE, SEE SHEET NO. 23

## PROPOSED PARTIAL PLAN- STA 28+50 TO STA 32+00

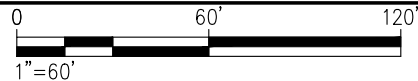

### LINETYPE LEGEND:

- MLW - - - - - MLW
- MHW - - - - - MHW
- SHT - - - - - SHT
- SHT-E - - - - - EXISTING SHT
- - - - - MAJOR CONTOUR
- - - - - MINOR CONTOUR
- (8' CLF) - - - - - NEW 8' CHAIN LINK FENCE
- - - - - CLL - CONTRACTOR LIMIT LINES
- - - - - TURBIDITY CURTAIN
- - - - - DEC ADJACENT AREA LINE
- - - - - REFERENCE LINE
- PROPOSED BERM
- STAGING AREA
- TEMPORARY GRAVEL ROADWAY

### NOTES:

1. THE SURVEY WAS COMPLETED BY MCLAREN ENGINEERING GROUP ON 03/18/2020.
2. VERTICAL DATUM IS FT NAVD88, HORIZONTAL DATUM IS NAVD88 NY LONG ISLAND STATE PLANE.
3. FEDERAL NAVIGATION CHANNEL IS APPROXIMATELY 1,300 FT FROM THIS PROJECT SITE.
4. CONSTRUCTION IS TO TAKE PLACE FROM THE SHORELINE, NOT THE WATER.
5. THE PROPOSED RIPRAP WILL INTRODUCE 8044 CY OF FILL VOLUME BELOW SHT-E AND 84,358 SQUARE FEET OF FILL AREA BELOW SHT-E.

### KEY PLAN

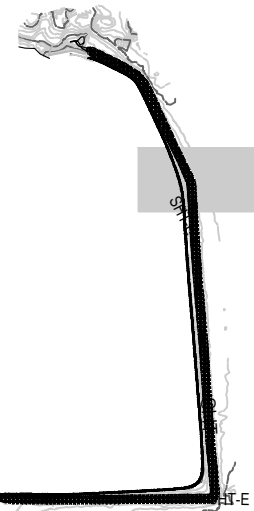

PURPOSE: SHORELINE STABILIZATION

DATUM: NAVD 88

ADJACENT OWNERS:

1. SEE ATTACHED LIST IN  
PERMIT PACKAGE.

AGENT: M.G. McLAREN, P.C.

131 W 35TH ST, 4TH FLR, NEW YORK, NY 10001

### PELHAM BAY LANDFILL

IN: EASTCHESTER BAY  
AT: BRONX AND PELHAM BAY PARKWAY  
COUNTY OF: BRONX STATE: NY

APPLICANT: NYC DEPARTMENT OF  
PARKS AND RECREATION  
117-02 ROOSEVELT AVENUE  
FLUSHING, NY 11368

PROPOSED PARTIAL PLAN-  
STA 28+50 TO STA 32+00

02/17/2023

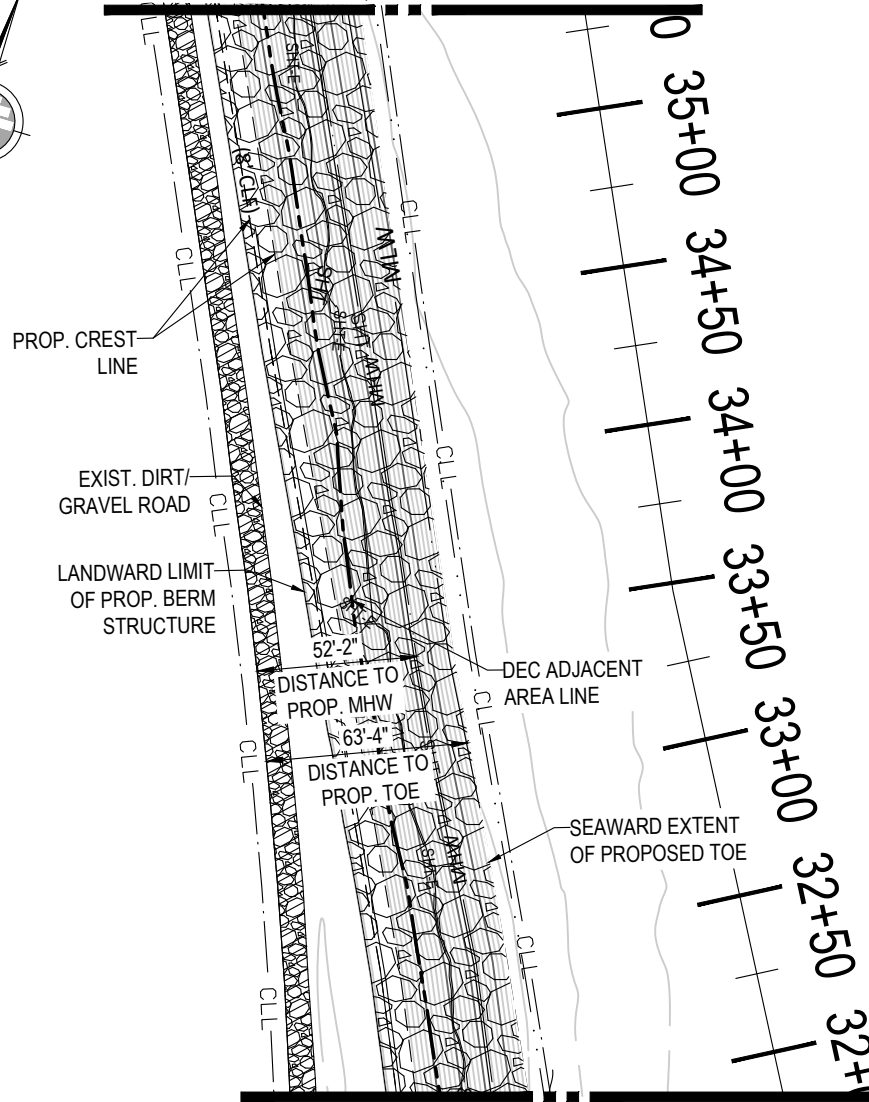

SHT 25 OF 30

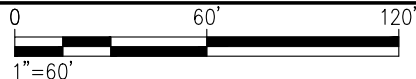

## PROPOSED PARTIAL PLAN- STA 32+00 TO STA 35+25



### LINETYPE LEGEND:

- MLW - - - - - MLW
- MHW - - - - - MHW
- SHT - - - - - SHT
- SHT-E - - - - - EXISTING SHT
- - - - - MAJOR CONTOUR
- - - - - MINOR CONTOUR
- (8' CLF) - - - - - NEW 8' CHAIN LINK FENCE
- - - - - CLL - CONTRACTOR LIMIT LINES
- - - - - TURBIDITY CURTAIN
- - - - - DEC ADJACENT AREA LINE
- - - - - REFERENCE LINE
-  PROPOSED BERM
-  TEMPORARY GRAVEL ROADWAY

### NOTES:

1. THE SURVEY WAS COMPLETED BY MCLAREN ENGINEERING GROUP ON 03/18/2020.
2. VERTICAL DATUM IS FT NAVD88, HORIZONTAL DATUM IS NAVD88 NY LONG ISLAND STATE PLANE.
3. FEDERAL NAVIGATION CHANNEL IS APPROXIMATELY 1,300 FT FROM THIS PROJECT SITE.
4. CONSTRUCTION IS TO TAKE PLACE FROM THE SHORELINE, NOT THE WATER.
5. THE PROPOSED RIPRAP WILL INTRODUCE 8044 CY OF FILL VOLUME BELOW SHT-E AND 84,358 SQUARE FEET OF FILL AREA BELOW SHT-E.

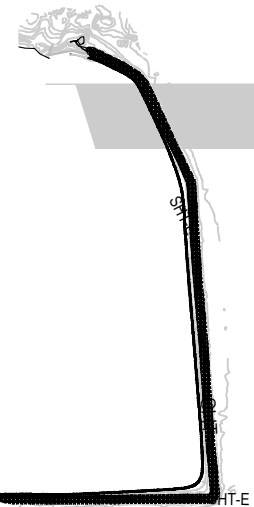

### KEY PLAN

PURPOSE: SHORELINE STABILIZATION

DATUM: NAVD 88

ADJACENT OWNERS:

1. SEE ATTACHED LIST IN PERMIT PACKAGE.

AGENT: M.G. McLAREN, P.C.

131 W 35TH ST, 4TH FLR, NEW YORK, NY 10001

### PELHAM BAY LANDFILL

IN: EASTCHESTER BAY  
AT: BRONX AND PELHAM BAY PARKWAY  
COUNTY OF: BRONX STATE: NY

APPLICANT: NYC DEPARTMENT OF  
PARKS AND RECREATION  
117-02 ROOSEVELT AVENUE  
FLUSHING, NY 11368

PROPOSED PARTIAL PLAN-  
STA 32+00 TO STA 35+25

02/17/2023

SHT 26 OF 30



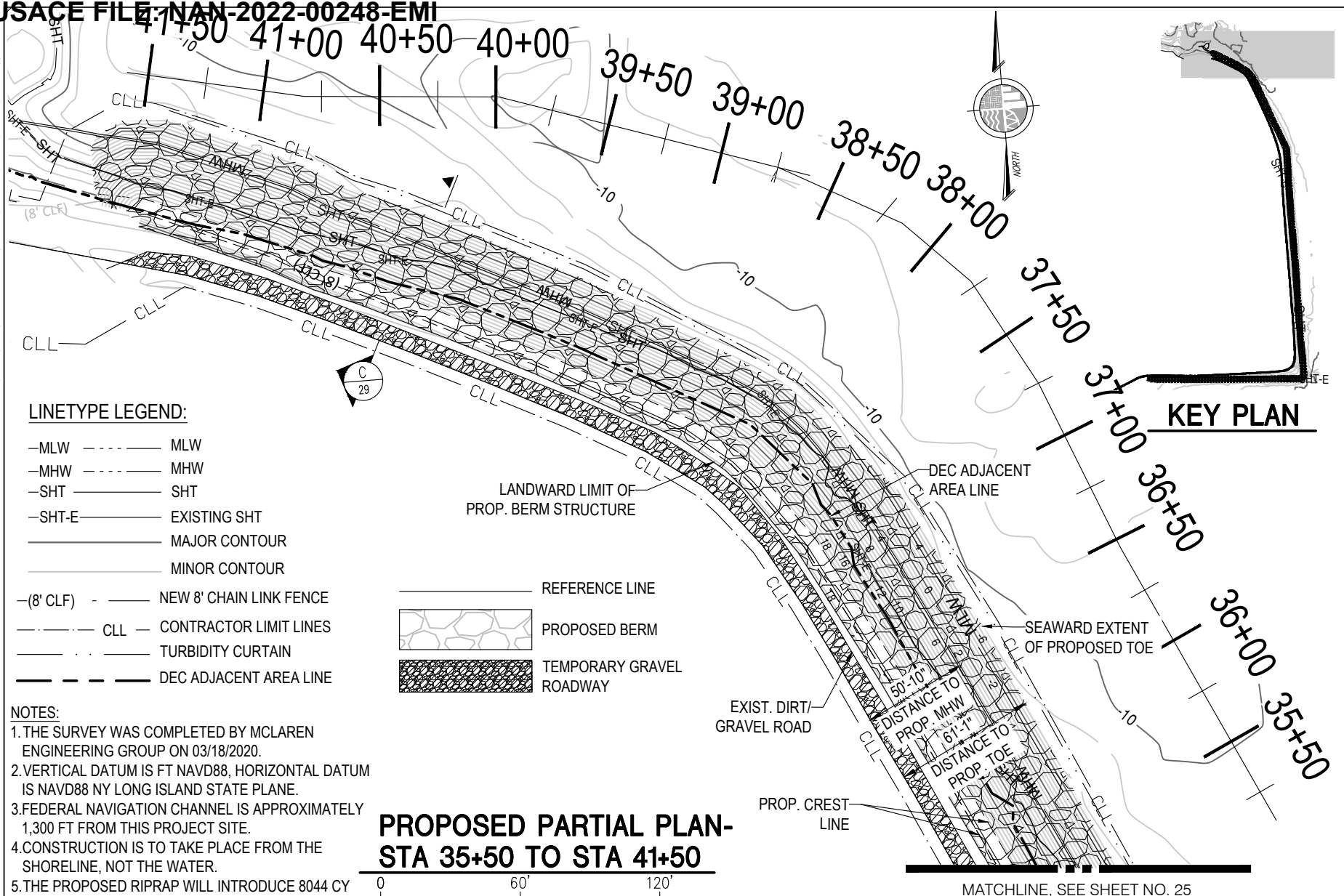

**KEY PLAN**

**LINETYPE LEGEND:**

- MLW - - - - - MLW
- MHW - - - - - MHW
- SHT - - - - - SHT
- SHT-E - - - - - EXISTING SHT
- - - - - MAJOR CONTOUR
- - - - - MINOR CONTOUR
- (8' CLF) - - - - - NEW 8' CHAIN LINK FENCE
- - - - - CLL - CONTRACTOR LIMIT LINES
- - - - - TURBIDITY CURTAIN
- - - - - DEC ADJACENT AREA LINE

- - - - - REFERENCE LINE
- [Pattern] PROPOSED BERM
- [Pattern] TEMPORARY GRAVEL ROADWAY

- NOTES:**
1. THE SURVEY WAS COMPLETED BY McLAREN ENGINEERING GROUP ON 03/18/2020.
  2. VERTICAL DATUM IS FT NAVD88, HORIZONTAL DATUM IS NAVD88 NY LONG ISLAND STATE PLANE.
  3. FEDERAL NAVIGATION CHANNEL IS APPROXIMATELY 1,300 FT FROM THIS PROJECT SITE.
  4. CONSTRUCTION IS TO TAKE PLACE FROM THE SHORELINE, NOT THE WATER.
  5. THE PROPOSED RIPRAP WILL INTRODUCE 8044 CY OF FILL VOLUME BELOW SHT-E AND 84,358 SQUARE FEET OF FILL AREA BELOW SHT-E.

**PROPOSED PARTIAL PLAN-  
STA 35+50 TO STA 41+50**

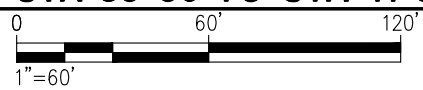

<p>PURPOSE: SHORELINE STABILIZATION                  DATUM: NAVD 88                  ADJACENT OWNERS:                  1. SEE ATTACHED LIST IN PERMIT PACKAGE.</p> <p>AGENT: M.G. McLAREN, P.C.                  131 W 35TH ST, 4TH FLR, NEW YORK, NY 10001</p>	<p style="text-align: center;">PELHAM BAY LANDFILL</p> <p>IN: EASTCHESTER BAY                  AT: BRONX AND PELHAM BAY PARKWAY                  COUNTY OF: BRONX STATE: NY</p> <p>APPLICANT: NYC DEPARTMENT OF PARKS AND RECREATION                  117-02 ROOSEVELT AVENUE                  FLUSHING, NY 11368</p>	<p>PROPOSED PARTIAL PLAN-                  STA 35+25 TO STA 41+50</p> <p>02/17/2023</p> <p>SHT 27 OF 30</p>
---	---	---

NAME: \\nyddad\projects\proj60160466\3110.Dwg\pelham bay landfill\CAAD\USACE\28 Proposed Sections.dwg PLOT TIME: Thu, 02 Mar 2023 - 10:00am LAST SAVE: Thu, 23 Feb 2023 - 10:30am BY: jgoces

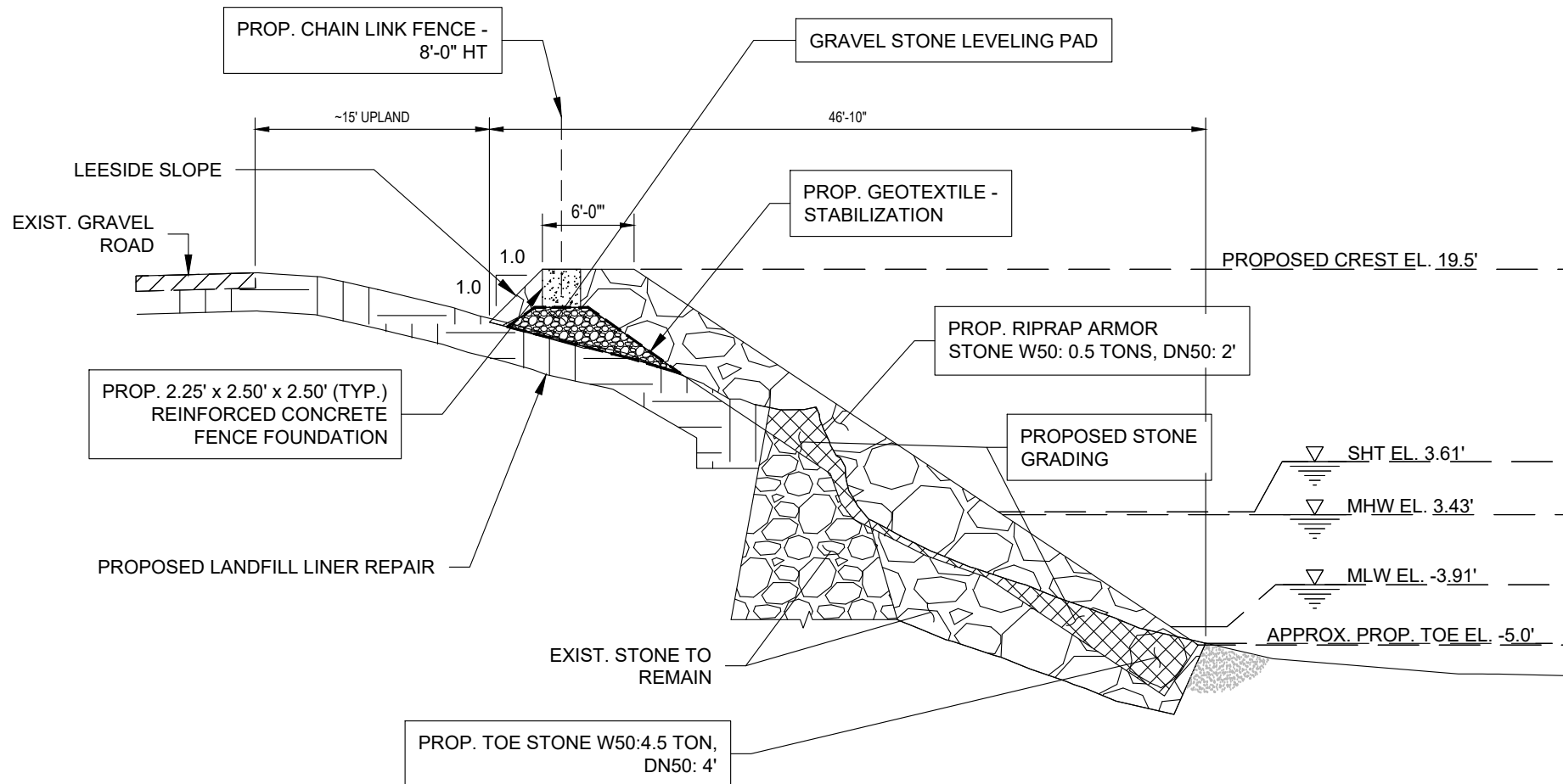

**A** **TYPICAL PROPOSED SECTION - STA 7+00**  
 28 3/32" = 1'-0"

**NOTE:**  
 1. LINER LOCATION IS BASED ON TYPICAL DETAIL FROM AS-BUILT DRAWING OF SEAWALL. LINER MAY CHANGE THROUGHOUT THE PERIMETER OF THE SEAWALL.

PURPOSE: SHORELINE STABILIZATION DATUM: NAVD 88 ADJACENT OWNERS: 1. SEE ATTACHED LIST IN PERMIT PACKAGE.  AGENT: M.G. McLAREN, P.C. 131 W 35TH ST, 4TH FLR, NEW YORK, NY 10001	PELHAM BAY LANDFILL		PROPOSED SECTIONS
	IN: EASTCHESTER BAY AT: BRONX AND PELHAM BAY PARKWAY COUNTY OF: BRONX STATE: NY	APPLICANT: NYC DEPARTMENT OF PARKS AND RECREATION 117-02 ROOSEVELT AVENUE FLUSHING, NY 11368	02/17/2023  SHT 28 OF 30

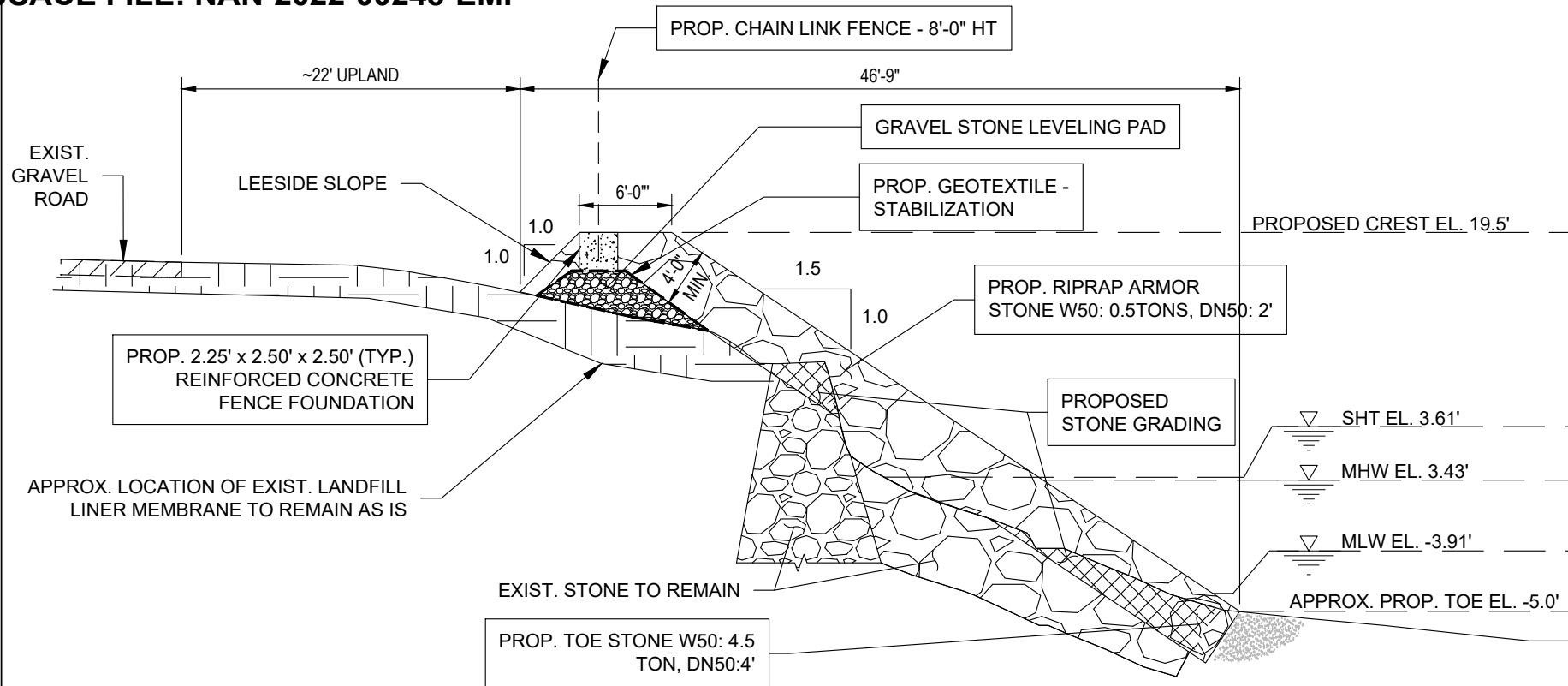

B

## TYPICAL PROPOSED SECTION - STA 25+75

29

 $3/32" = 1'-0"$ 

## NOTE:

1. LINER LOCATION IS BASED ON TYPICAL DETAIL FROM AS-BUILT DRAWING OF SEAWALL. LINER MAY CHANGE THROUGHOUT THE PERIMETER OF THE SEAWALL.

PURPOSE: SHORELINE STABILIZATION

DATUM: NAVD 88

ADJACENT OWNERS:

1. SEE ATTACHED LIST IN PERMIT PACKAGE.

AGENT: M.G. McLAREN, P.C.

131 W 35TH ST, 4TH FLR, NEW YORK, NY 10001

## PELHAM BAY LANDFILL

IN: EASTCHESTER BAY  
AT: BRONX AND PELHAM BAY PARKWAY  
COUNTY OF: BRONX STATE: NY

APPLICANT: NYC DEPARTMENT OF  
PARKS AND RECREATION  
117-02 ROOSEVELT AVENUE  
FLUSHING, NY 11368

## PROPOSED SECTIONS II

02/17/2023

SHT 29 OF 30

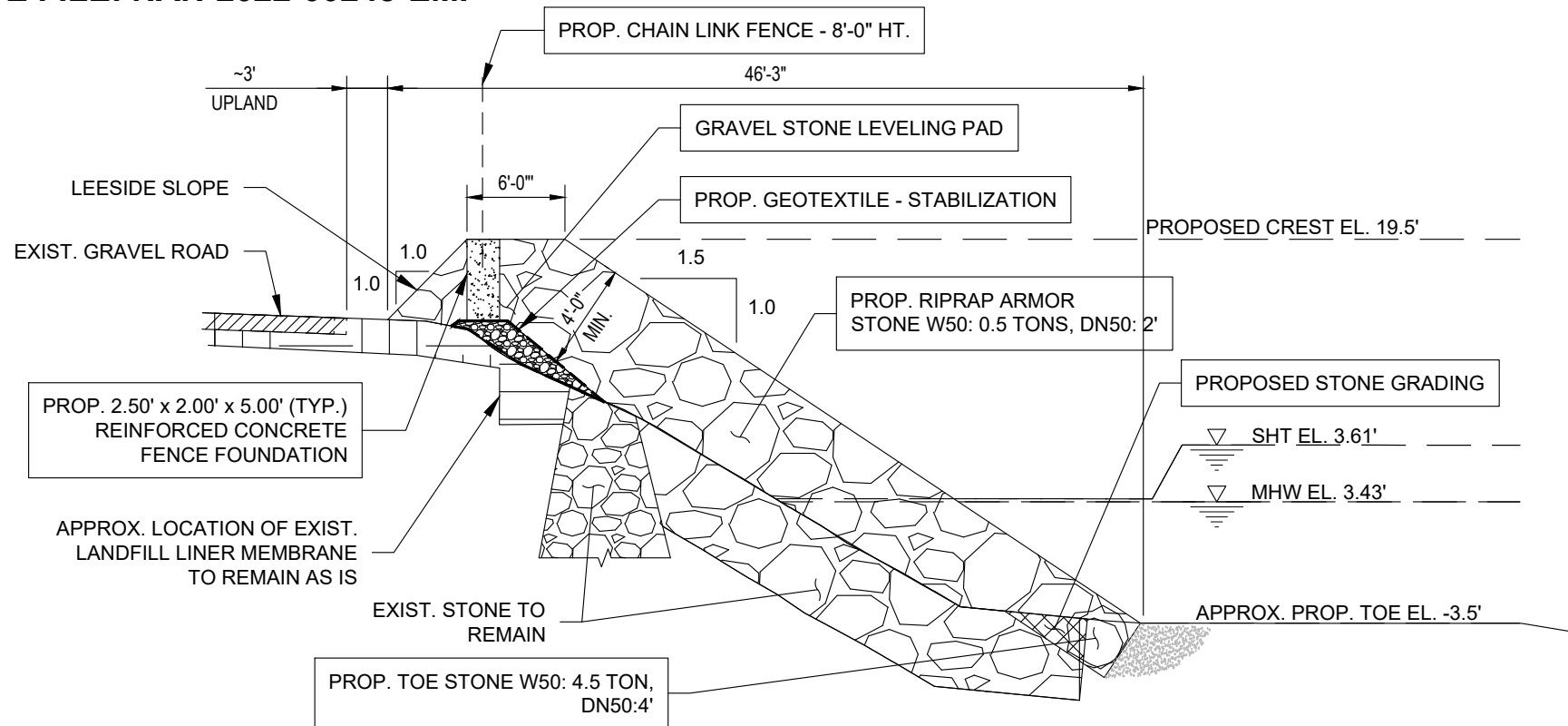

C

## TYPICAL PROPOSED SECTION - STA 40+50

30

3/32" = 1'-0"

## NOTE:

1. LINER LOCATION IS BASED ON TYPICAL DETAIL FROM AS-BUILT DRAWING OF SEAWALL. LINER MAY CHANGE THROUGHOUT THE PERIMETER OF THE SEAWALL.

PURPOSE: SHORELINE STABILIZATION

DATUM: NAVD 88

ADJACENT OWNERS:

1. SEE ATTACHED LIST IN PERMIT PACKAGE.

AGENT: M.G. McLAREN, P.C.

131 W 35TH ST, 4TH FLR, NEW YORK, NY 10001

## PELHAM BAY LANDFILL

IN: EASTCHESTER BAY  
AT: BRONX AND PELHAM BAY PARKWAY  
COUNTY OF: BRONX STATE: NY

APPLICANT: NYC DEPARTMENT OF  
PARKS AND RECREATION  
117-02 ROOSEVELT AVENUE  
FLUSHING, NY 11368

## PROPOSED SECTIONS III

02/17/2023

SHT 30 OF 30